

DIMENSIONS

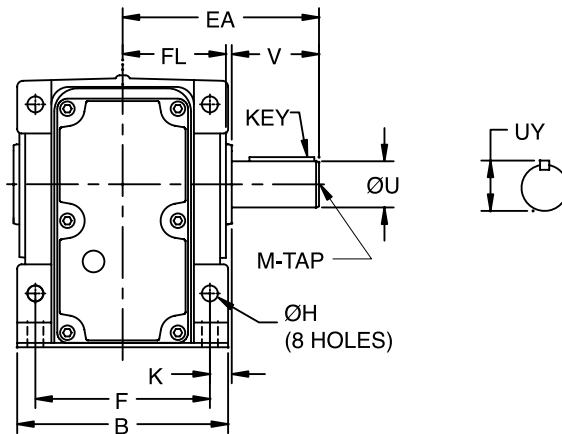

RHB Foot Mounted, Clamp Collar C-Face Gearmotors - Solid Output Shaft

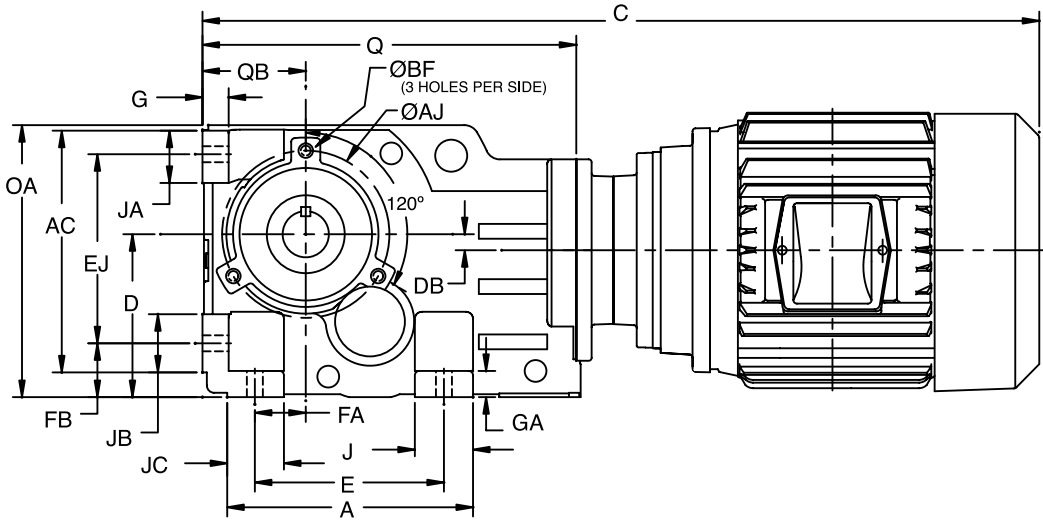

FEATURES/BENEFITS PAGE G2-2	HOW TO ORDER PAGE G2-3	SELECTION PAGE G2-22	DIMENSIONS PAGE G2-26
--------------------------------	---------------------------	-------------------------	--------------------------

DIMENSIONS



RHB Foot Mounted, Clamp Collar C-Face Gearmotors - Solid Output Shaft

Size	Frame Size	A	B	C *	D	E	F	G	ØH	J	K	Q	V	AC	ØAJ	ØBF	DB
BB38	56C	5.55	4.72	22.86	3.94	4.33	3.94	0.63	0.43	1.26	0.39	8.94	1.97	5.79	3.94	M8 x .55 DEEP	0.37
	140TC			25.59													
	180TC			27.92													
BB48	56C	6.65	5.71	24.04	4.41	5.12	4.72	0.71	0.43	1.58	0.59	10.12	2.36	6.54	4.53	M10 x .66 DEEP	0.43
	140TC			26.77													
	180TC			29.11													
BB68	56C	6.69	6.69	25.92	5.51	4.72	5.51	0.87	0.53	1.97	0.79	12.21	3.15	8.19	5.12	M12 x .82 DEEP	0.26
	140TC			28.65													
	180TC			30.99													
BB88	56C	8.07	7.87	28.21	7.09	5.91	6.50	0.98	0.71	2.17	0.89	14.72	3.94	10.31	6.50	M12 x .82 DEEP	0.79
	140TC			30.94													
	180TC			33.28													
	210TC			39.08													

Size	EA	EJ	FA	FB	FL	GA	JA	JB	JC	OA	QB	ØU	UY	KEY	M-TAP
BB38	4.33	4.53	1.10	1.26	2.28	0.63	1.22	1.30	1.38	6.58	2.48	1.000	1.11	1/4 x 1/4 x 1-5/8	3/8-16 UNC x 0.87
BB48	5.31	5.12	1.38	1.46	2.80	0.71	1.42	1.58	1.54	7.36	2.80	1.250	1.37	1/4 x 1/4 x 1-7/8	3/8-16 UNC x 0.87
BB68	6.69	6.30	1.18	1.77	3.39	0.87	1.89	1.97	1.97	9.09	3.54	1.625	1.80	3/8 x 3/8 x 2-5/8	5/8-11 UNC x 1.42
BB88	8.07	7.87	1.58	2.17	3.94	0.98	2.56	2.17	2.17	11.61	4.41	2.000	2.22	1/2 x 1/2 x 3-1/4	5/8-11 UNC x 1.42

* Actual C dimension depends on exact motor used.

FEATURES/BENEFITS PAGE G2-2	HOW TO ORDER PAGE G2-3	SELECTION PAGE G2-22	DIMENSIONS PAGE G2-26
--------------------------------	---------------------------	-------------------------	--------------------------