

# MODIFICATIONS/ ACCESSORIES



## MAXUM Concentric Reducer

Table 12: Accessory Compatibility For Combinations Of  
MAXUM Reducers And Accessories ▲

REDUCER		ACCESSORIES				
SIZE	CONFIGURATION	AUX. SEAL	BACK-STOP	COOLING-FAN	BS. & C.F.	SLIDE BASE
4	SEPARATE	YES	YES	YES	*	YES
	SCOOP MOUNT	YES	YES**	YES**	*	YES
	BASEPLATE	YES	YES	YES	*	YES*
	TOP MOUNT	YES	YES	*	*	YES

REDUCER		ACCESSORIES				
SIZE	CONFIGURATION	AUX. SEAL	BACK-STOP	COOLING-FAN	BS. & C.F.	SLIDE BASE
5	SEPARATE	YES	YES	YES 1	*	YES
	SCOOP MOUNT	YES	YES**	YES**1	*	YES
	BASEPLATE	YES	YES	YES 1	*	YES*
	TOP MOUNT	YES	YES	*	*	YES

REDUCER		ACCESSORIES				
SIZE	CONFIGURATION	AUX. SEAL	BACK-STOP	COOLING-FAN	BS. & C.F.	SLIDE BASE
6	SEPARATE	YES	YES	YES 1	*	YES
	SCOOP MOUNT	YES	YES**	YES**1	*	YES
	BASEPLATE	YES	YES	YES 1	*	YES*
	TOP MOUNT	YES	YES	*	*	YES

▲ Consult DODGE for combinations not listed

\* Consult DODGE, made-to-order accessory combination

YES Stock accessory combination is compatible

\*\* Non-stock coupling guard required

1 Standard cooling fan compatible only with these reducer sizes and ratios:  
MAXUM 5 and 6, 2.25 - 25.63  
Contact DODGE for other ratios."



## MAXUM Concentric Reducer

**Table 12: Accessory Compatibility For Combinations Of MAXUM Reducers And Accessories ▲**

REDUCER		ACCESSORIES				
SIZE	CONFIGURATION	AUX. SEAL	BACK-STOP ◆ ●	COOL-ING-FAN	BS. & C.F. ◆	SLIDE BASE
7	SEPARATE	YES	YES	YES 1	*	YES
	SCOOP MOUNT	YES	YES**	YES** 1	*	YES
	BASEPLATE	YES	YES	YES 1	*	YES*
	TOP MOUNT	YES	*	*	*	YES

REDUCER		ACCESSORIES				
SIZE	CONFIGURATION	AUX. SEAL	BACK-STOP ◆ ●	COOL-ING-FAN	BS. & C.F. ◆	SLIDE BASE
11	SEPARATE	YES	YES	YES	YES 2	YES
	SCOOP MOUNT	YES	YES** 3	YES**	YES** 3 2	YES
	BASEPLATE	YES	YES	YES	YES 2	YES*
	TOP MOUNT	YES	*	*	*	YES

REDUCER		ACCESSORIES				
SIZE	CONFIGURATION	AUX. SEAL	BACK-STOP ◆ ●	COOL-ING-FAN	BS. & C.F. ◆	SLIDE BASE
9	SEPARATE	YES	YES	YES 1	YES 2	YES
	SCOOP MOUNT	YES	YES** 3	YES** 1	YES** 3 2	YES
	BASEPLATE	YES	YES	YES 1	YES 2	YES*
	TOP MOUNT	YES	*	*	*	YES

REDUCER		ACCESSORIES				
SIZE	CONFIGURATION	AUX. SEAL	BACK-STOP ◆ ●	COOL-ING-FAN	BS. & C.F. ◆	SLIDE BASE
12	SEPARATE	YES	YES	YES	YES 2	YES
	SCOOP MOUNT	YES	YES** 3	YES**	YES** 3 2	YES
	BASEPLATE	YES	YES	YES	YES 2	YES*
	TOP MOUNT	YES	*	*	*	YES

REDUCER		ACCESSORIES				
SIZE	CONFIGURATION	AUX. SEAL	BACK-STOP ◆ ●	COOL-ING-FAN	BS. & C.F. ◆	SLIDE BASE
10	SEPARATE	YES	YES	YES	YES 2	YES
	SCOOP MOUNT	YES	YES** 3	YES**	YES** 3 2	YES
	BASEPLATE	YES	YES	YES	YES 2	YES*
	TOP MOUNT	YES	*	*	*	YES

- ▲ Consult DODGE for combination not listed
- \* Consult DODGE, made-to-order accessory combination
- YES Stock accessory combination is compatible
- \*\* Non-stock coupling guard required

- 1 Standard cooling fan compatible only with these reducer sizes and ratios:  
MAXUM 7, 2.25 - 25.63  
MAXUM 9, 5.06 - 25.63  
Contact DODGE for other ratios.

- 2 Standard backstop and cooling fan compatible only with these reducer sizes and ratios:  
MAXUM 8 and 9, 5.06 - 25.63  
MAXUM 10, 5.06 - 70.62  
MAXUM 11, 5.06 - 70.62  
MAXUM 12, 6.20 - 70.62  
Contact DODGE for other ratios.

- ◆ When using external backstops on sizes 7 through 12 reducers with scoops, see page G3-37 for UA and NA dimensions. Change out TL Bushing or Finish bore hub to fit smaller input shaft diameter of backstop reducer.

3 Non-Stock motor plate required for these reducers and scoop packages

RED. SIZE	RATIO	MTR FRAME SIZE	MTR. PLT. PART #
MAXUM 9	5.06 - 25.6	213T - 365T	299488
MAXUM 9	5.06 - 25.6	404T - 445T	299489
MAXUM 10 and 11	5.06 - 70.62	213T - 365T	299488
MAXUM 10 and 11	5.06 - 70.62	404T - 445T	299489
MAXUM 12	6.20 - 70.62	213T - 365T	299488
MAXUM 12	6.20 - 70.62	404T - 445T	299489

- Maximum 7 thru 12 Top Motor Mount applications with external backstops must be checked for over hung load.

# MODIFICATIONS/ ACCESSORIES



## MAXUM Concentric Reducer

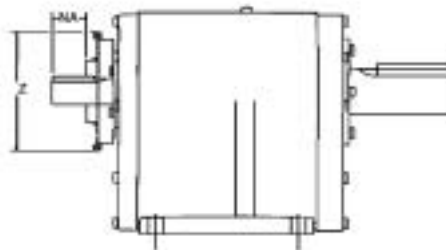

### BACKSTOP ASSEMBLIES

Optional backstops are offered for service conditions that require the prevention of reverse direction. All backstops are externally mounted on the high speed shaft. On reducer sizes 1 through 6, the backstop is a ratchet and pawl type that does not require additional shaft length to mount. On sizes 7 through 12, a sprag type backstop mounts on an extended high speed shaft which is supplied with the backstop reducer.

**NOTE:** All backstops have a maximum overrunning speed limitation of 1800 RPM. In addition, the ratchet and pawl type on reducer sizes 1-6 has a minimum overrunning speed limitation of 400 RPM.

When ordering a reducer with backstop, it will be necessary to indicate on the order the desired direction of rotation of the output shaft, either by designating "CW" for clockwise or "CCW" for counter clockwise, when looking at the output shaft. Backstop is factory installed on sizes 7-12, specify rotation. Sizes 1-6 factory installed upon request. For sizes 1-3, check availability.

### External Backstops (sizes 1 thru 6) ■

Unit Size	Ratios +	Part Number	NA	Z	Backstop Max. HP
DCR/TCR 1	2.25-194.6	299375	1.53	8.69	30
DCR/TCR 2	2.25-194.6	299375	1.53	8.69	30
DCR/TCR 3	7.59-194.6	299375	1.97	8.69	50
DCR/TCR 4	13.95-194.6	299375	1.97	8.69	50
DCR 5	9.30-25.63	299377	2.69	9.75	75
TCR 5	31.39-194.6	299377	1.61	9.75	50
DCR 6	13.95-25.63	299377	2.69	9.75	75
TCR 6	31.39-194.6	299377	1.61	9.75	50

+ For backstops on ratios not listed, application HP can not exceed the backstop maximum HP rating.

■ Refer to Table 12, page G3-34 for compatibility of various combinations of reducers and accessories.

■ Sizes 1-3 discontinued. Remaining stock may be available

**WARNING:** Backstops are not to be used for applications involving energy absorption and shock or torque loads in excess of reducer ratings nor on applications such as chair lifts, amusement rides, etc., and where the safety of persons or property is dependent on their function. On such applications, other holding devices must be provided.



## MAXUM Concentric Reducer EXTERNAL BACKSTOPS (SIZE 7 THRU 12) ■

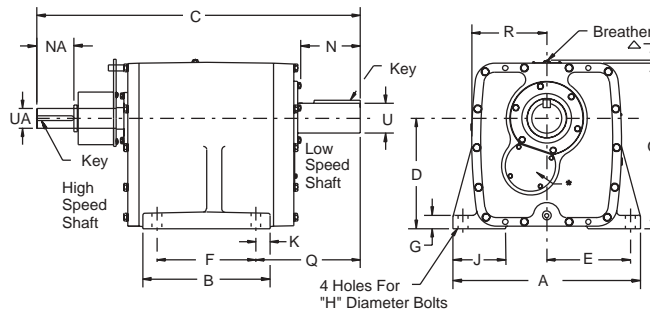

△ 1-1/2" will clear breather on all size units.

Size	Ratios	Part Number *	C	NA	UA	
					Shaft Diameter	Key
DCR 7	5.06-25.63	299379	41.97	3.75	1.999/1.998	1/2 x 31/2
TCR 7	31.39-194.6	299380	40.79	2.69	1.311/1.310	5/16 x 21/2
DCR 9	5.06-11.39	299384	53.46	3.75	2.7485/2.7475	5/8 x 31/2
DCR 9	13.95-25.63	299385	52.08	3.75	1.999/1.998	1/2 x 31/2
TCR 9	31.39-194.6	299386	49.47	3.75	1.999/1.998	1/2 x 31/2
DCR 10	5.06-11.39	299387	54.27	3.75	2.7485/2.7475	5/8 x 31/2
DCR/TCR 10	13.95-70.62	299388	52.90	3.75	1.999/1.998	1/2 x 31/2
TCR 10	86.50-194.6	299389	50.38	3.75	1.999/1.998	1/2 x 31/2
DCR 11	5.06-11.39	299390	57.19	3.75	3.2485/3.2475	3/4 x 31/2
DCR 11	13.95-25.63	299391	55.94	3.75	2.7485/2.7475	5/8 x 31/2
TCR 11	31.39-70.62	299392	54.57	3.75	1.999/1.998	1/2 x 31/2
TCR 11	86.50-194.6	299845	52.79	3.75	1.999/1.998	1/2 x 31/2
DCR 12	6.20-11.39	299393	57.72	3.75	3.2485/3.2475	3/4 x 31/2
DCR 12	13.95-25.63	299394	56.48	3.75	2.7485/2.7475	5/8 x 31/2
TCR 12	31.39-70.62	299395	55.10	3.75	1.999/1.998	1/2 x 31/2
TCR 12	86.50-194.6	299846	53.36	3.75	1.999/1.998	1/2 x 31/2

\* External backstop assembly only. See Specification/Dimensions Section pages G3-23 through G3-33 for MAXUM Backstop Reducer part numbers. (Reducers have extended high speed shafts for mounting of external backstops.)

### MAXUM REDUCER BASIC DIMENSIONS

Unit Size	A	B	D	E	F	G	H	J	N	O	Q	R	U	
													Shaft Dia.	Key Size
7	25.49	18.50	14.80	11.22	14.70	1.80	11/4	7.06	8.05	22.31	14.09	10.17	4.00	1 x 1 x 6-1/4
9	31.50	22.00	18.13	13.44	18.19	2.19	11/2	10.00	10.67	27.38	17.49	11.94	5.25	1-1/4 x 1-1/4 x 8-13/16
10	29.93	24.00	18.38	13.10	20.25	2.25	11/2	9.00	11.00	28.43	16.67	12.76	6.00	1-1/2 x 1-1/2 x 8-3/4
11	33.02	24.25	20.75	14.44	20.38	2.50	13/4	9.00	11.51	32.11	17.93	14.54	6.50	1-1/2 x 1-1/2 x 9-1/4
12	34.46	24.88	23.38	15.20	21.00	2.75	13/4	9.00	12.00	35.79	18.17	16.18	7.00	1-3/4 x 1-3/4 x 9-5/32

Refer to Table 12, page G3-34 for compatibility of various combinations of reducers and accessories

FEATURES/BENEFITS PAGE G3-3	NOMENCLATURE PAGE G3-6	EASY SELECTION PAGE G3-7	RELATED PRODUCTS PAGE G3-55
--------------------------------	---------------------------	-----------------------------	--------------------------------

# MODIFICATIONS/ ACCESSORIES

**DODGE®**

## MAXUM Concentric Reducer

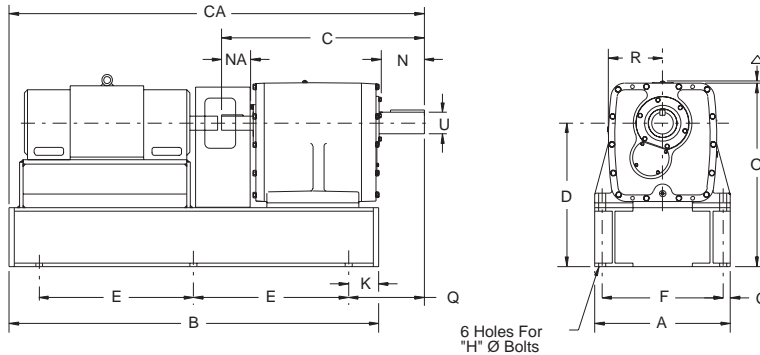

6 Holes For  
"H" Ø Bolts

△ 1-1/2" will clear breather on all reducers.

### HD BASEPLATE ASSEMBLIES

Heavy Duty Baseplates are rigid units fabricated of heavy steel, providing a sturdy mounting base for motor/coupling/reducer combinations. This accessory is recommended for large motors where the motor weight exceeds the reducer weight or 700 lbs. and for variable speed DC or AC application regardless of the motor weight. The combination of a factory mounted Reliance motor, DODGE coupling, MAXUM reducer and HD baseplate becomes a drive package warranted as a single system.

HD baseplate assemblies include baseplate, Para-Flex coupling and coupling guard.

When mounting variable speed AC or DC motors, consult general guidelines on pages G3-81 and G3-82.

**Consult DODGE for size 7-12 baseplate dimensions.**



FEATURES/BENEFITS PAGE G3-3	NOMENCLATURE PAGE G3-6	EASY SELECTION PAGE G3-7	RELATED PRODUCTS PAGE G3-55
--------------------------------	---------------------------	-----------------------------	--------------------------------



## MAXUM Concentric Reducer

### MAXUM REDUCER HD BASEPLATES WITH RELIANCE RPM III DC MOTORS ▲

Reducer/Motor*	B	CA	E	A	C	D	F	G	H	K	N	O	R	U	Q	NA	
DCR/TCR 1	1811	38.50	43.22	17.25	11.75	18.67	12.80	10.40	0.68	1/2"	2.00	3.50	16.64	4.94	1.750	6.72	3.05
	1812	38.50	43.22	17.25													
	2113	48.00	52.72	22.00													
DCR/TCR 2	1811	40.50	44.96	17.25	12.75	20.63	13.50	11.20	0.77	5/8"	3.00	4.25	17.50	5.13	2.125	7.46	3.05
	1812	40.50	44.96	17.25													
	2113	50.50	54.96	22.25													
DCR/TCR 3	2512	53.00	57.46	23.50	15.25	23.08	15.00	13.20	1.02	3/4"	3.00	5.25	19.88	6.19	2.625	8.78	3.50
	1811	42.00	47.78	18.00													
	1812	42.00	47.78	18.00													
	2113	51.50	57.28	22.75													
	2512	54.50	60.28	24.25													
DCR/TCR 4	2812	59.00	64.78	26.50	16.88	25.47	18.10	14.60	1.14	7/8"	3.00	5.75	22.97	6.69	2.875	9.45	3.50
	1811	43.50	49.95	18.75													
	1812	43.50	49.95	18.75													
	2113	53.00	59.45	23.50													
	2512	56.00	62.45	25.00													
	2812	60.50	66.95	27.25													
	3210	62.50	68.95	28.25													
DCR5	3212	62.50	68.95	28.25	18.63	29.14	18.46	16.40	1.11	1"	3.00	6.75	23.94	7.44	3.375	10.75	4.51
	1811	45.50	53.25	19.75													
	1812	45.50	53.25	19.75													
	2113	55.00	62.75	24.50													
	2512	58.50	66.25	26.25													
	2812	63.00	70.75	28.50													
	3210	64.50	72.25	29.25													
TCR5	3212	64.50	72.25	29.25	18.63	28.05	18.46	16.40	1.11	1"	3.00	6.75	23.94	7.44	3.375	10.75	3.42
	1811	45.00	52.75	19.50													
	1812	45.00	52.75	19.50													
	2113	54.50	62.25	24.25													
	2512	57.50	65.25	25.75													
	2812	62.00	69.75	28.00													
	3210	63.50	71.25	28.75													
DCR6	3212	63.50	71.25	28.75	21.38	31.44	20.16	18.60	1.39	11/8"	3.00	7.50	26.66	8.16	3.750	11.91	4.51
	1811	46.50	55.41	20.25													
	1812	46.50	55.41	20.25													
	2113	56.00	64.91	25.00													
	2512	60.50	69.41	27.25													
	2812	64.00	73.91	29.00													
	3210	65.50	74.41	29.75													
	3212	65.50	74.41	29.75													
	3612	71.00	79.91	32.50													
TCR6	1811	46.00	54.91	20.00	21.38	30.36	20.16	18.60	1.39	11/8"	3.00	7.50	26.66	8.16	3.750	11.91	3.42
	1812	46.00	54.91	20.00													
	2113	55.50	64.41	24.75													
	2512	58.50	67.41	26.25													
	2812	63.00	71.91	28.50													
	3210	64.50	73.41	29.25													
	3212	64.50	73.41	29.25													
	3612	70.00	78.91	32.00													

▲ For dimensions on HD Baseplates for sizes 7-12, consult DODGE.

\* All motors are suffixed by "ATZ." Reliance RPM III motors used as a guide for dimensions.

Consult DODGE when mounting non-Reliance Electric motors.

Sizes 1-3 discontinued. Remaining stock may be available

FEATURES/BENEFITS PAGE G3-3	NOMENCLATURE PAGE G3-6	EASY SELECTION PAGE G3-7	RELATED PRODUCTS PAGE G3-55
--------------------------------	---------------------------	-----------------------------	--------------------------------

# MODIFICATIONS/ ACCESSORIES



## MAXUM Concentric Reducer

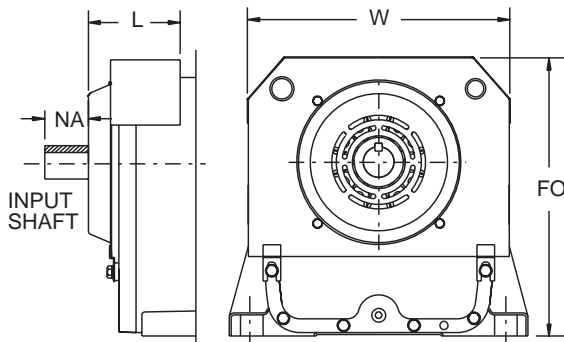

### COOLING FANS

When the thermal capacity of the MAXUM Concentric Shaft Reducer is exceeded, cooling fans provide an optional, inexpensive way of lowering the oil temperature thus increasing the thermal horsepower capacity of the reducer. Selection tables indicate the need for cooling fans. Refer to the thermal tables on pages G3-68 and G3-69. For thermal capacities beyond the range of cooling fans, heat exchangers may be used - see below. Installation of the fan is accomplished simply by attaching formed steel mounting straps to the reducer input cover. The fan assembly, which fastens to the reducer high speed shaft, is simple and compact yet designed to allow an efficient flow of air.

**NOTE:** When using fans with backstops or top motor mounts, see **Accessory Compatibility Matrix**, page G3-34, or consult DODGE.

**NOTE:** Viton seals are available for MAXUM reducers in high temperature applications. Consult DODGE.

Dimensions for MAXUM Reducer with Cooling Fan

Unit Size	Part Number	NA	L	W	FO
DCR 3	299519	1.78	5.75	14.50	15.00
DCR 4	299520	1.78	5.75	14.50	16.13
DCR 5	299521	2.69	6.69	17.00	17.44
DCR 6	299522	2.69	6.69	18.75	19.94
DCR 7	299523	3.75	7.94	22.44	24.00
DCR 9	299525	3.75	10.19	26.38	29.00
DCR 10	299526	3.75	10.19	28.00	29.94
TCR 10	299842	3.75	10.19	28.00	29.94
DCR 11	299527	3.75	10.19	31.63	33.75
TCR 11	299843	3.75	10.19	31.63	33.75
DCR 12	299528	3.75	10.19	33.75	37.44
TCR 12	299844	3.75	10.19	33.75	37.44

Sizes 1-3 discontinued. Remaining stock may be available

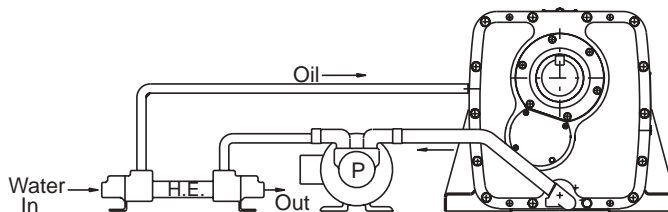

### HEAT EXCHANGER COOLING PACKAGES

For thermal capacities beyond the range of cooling fans, an optional heat exchanger cooling package is available to achieve the use of full mechanical HP rating by lowering the oil temperature.

The cooling package is available to cover the basic reducer sizes 3 through 12. (See thermal HP table on pages G3-68 and G3-69.)

Specifications for the heat exchanger motor are as follows: 1/2 HP, 60 Hz, 3 Ph, 230/460 Volt, TEFC, 56 Frame. Minimum coolant (water) flow is 3 G.P.M. based upon a maximum water temperature of 80°F. Minimum oil temperature for operation is 60°F.

Available from stock as part number **014148**.

FEATURES/BENEFITS  
PAGE G3-3

NOMENCLATURE  
PAGE G3-6

EASY SELECTION  
PAGE G3-7

RELATED PRODUCTS  
PAGE G3-55



## MAXUM Concentric Reducer



### SCOOP MOUNT MOTOR/REDUCERS

DODGE MAXUM Scoop Mount Motor/Reducers are available in 12 sizes ranging from 1 to 250 horsepower. Case sizes 4-6 feature AGMA standard speeds 9 to 778 RPM, and case sizes 7-12 feature AGMA standard speeds from 9 to 350 RPM.

DODGE MAXUM Scoop Mount Motor/Reducers can be supplied with factory-mounted Reliance AC motors. Or, if preferred, scoop mount reducers may be ordered separately for use with customer supplied AC motors. Gray iron cases come with steel scoops designed to accept NEMA AC motor frame sizes from 143T through 445T.

DODGE flexible PARA-FLEX® couplings are standard, however, DODGE grid couplings are also available as an optional item.

Thermally limited DODGE MAXUM Scoop Mount Motor/Reducers should be equipped with cooling fan or heat exchanger as required.

Scoops can be used in conjunction with some other accessories. Refer to Table 12, page G3-34.

**CAUTION:** The customer is responsible and Reliance Electric expressly disclaims responsibility for isolating the DODGE MAXUM Scoop Mount Motor/Reducer from any vibratory or transient load induced by the motor or the other equipment that is driven by the motor.

The MAXUM Scoop Mount Motor/Reducer is expressly not warranted against failure or unsatisfactory operation

resulting from dynamic vibrations of any form imposed upon it whether by the drive system in which it is installed or for any other reason, no matter how induced, unless the nature of such vibrations has been fully defined by the customer on the face of its purchase order and explicitly accepted in writing by Reliance Electric.

### DRIVE SYSTEM VIBRATION

The probability of a constant speed motor operating at resonant frequency is remote. Should this occur however, the customer must add stiffening supports to the scoop bottom

plate to move the resonant frequency away from the motor operating speed.

When mounting variable speed AC or DC motors, consult guidelines on page G3-81 and G3-82.

FEATURES/BENEFITS PAGE G3-3	NOMENCLATURE PAGE G3-6	EASY SELECTION PAGE G3-7	RELATED PRODUCTS PAGE G3-55
--------------------------------	---------------------------	-----------------------------	--------------------------------

# MODIFICATIONS/ ACCESSORIES



## MAXUM Concentric Reducer

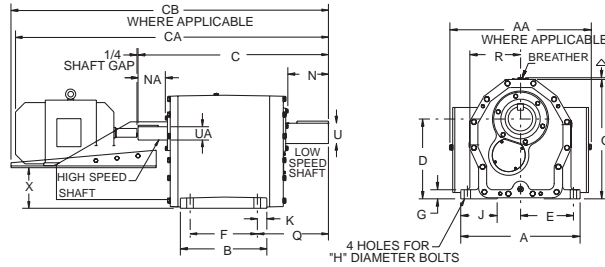

### SCOOP MOUNT MOTOR/REDUCERS WITH AC MOTORS, SIZE 1-4 (WITHOUT EXTERNAL BACKSTOP)

MAXUM Size	A	B	C		D	E	F	G	H Bolts	J	K	N	NA	
			Double Red. Units	Triple Red. Units									Dbl. Red. Units w/o Fan	Triple Red. Units
1	11.75	7.25	18.67	18.67	6.30	5.20	6.00	0.69	1/2	2.88	.63	3.50	3.05	3.05
2	12.75	8.50	20.63	20.63	7.00	5.60	7.13	0.81	5/8	3.28	.69	4.25	3.05	3.05
3	15.25	9.50	23.08	23.08	8.50	6.60	7.75	0.94	3/4	4.31	.88	5.25	3.50	3.50
4	16.88	11.25	25.47	25.47	9.60	7.30	9.00	1.13	7/8	4.50	.92	5.75	3.50	3.50

MAXUM Size	O	Q	R	U		UA				Avg. Reducer Wt. (lbs.)
				Shaft Dia	Key Size	Dbl. Reduction Units		Triple Reduction Units		
						Shaft Dia	Key Size	Shaft Dia	Key Size	
1	10.14	6.72	4.94	1.750	3/8 x 3/8 x 2-3/4	1.375	5/16 x 5/16 x 2-3/16	1.375	5/16 x 5/16 x 2-3/16	130
2	11	7.46	5.13	2.125	1/2 x 1/2 x 3-1/4	1.375	5/16 x 5/16 x 2-3/16	1.375	5/16 x 5/16 x 2-3/16	167
3	13.38	8.78	6.19	2.625	5/8 x 5/8 x 4-11/16	1.625	3/8 x 3/8 x 2-1/2	1.625	3/8 x 3/8 x 2-1/2	240
4	14.47	9.45	6.69	2.875	3/4 x 3/4 x 5	1.625	3/8 x 3/8 x 2-1/2	1.625	3/8 x 3/8 x 2-1/2	340

MAXUM Size	Dimensional Ref.	143T	145T	182T	184T	213T	215T	254T	256T	284T	286T	324T	326T
		1	AA❖ CA+ CB X	13.60 30.42 34.14 2.55	13.60 32.42 34.14 2.55	13.60 33.54 34.14 1.55	13.60 34.54 N/A 1.55	13.60 36.73 N/A 0.80	13.60 38.23 N/A 0.80				
2	AA❖ CA+ CB X	16.77 32.38 41.10 3.19	16.77 34.38 41.10 3.19	16.77 35.50 41.10 2.19	16.77 36.50 41.10 2.19	16.77 38.69 41.10 1.44	16.77 40.19 41.10 1.44	16.77 16.77 N/A 0.44	16.77 43.38 N/A 0.44				
3	AA❖ CA+ CB X	16.77 34.83 43.55 4.69	16.77 36.83 43.55 4.69	16.77 37.95 43.55 3.69	16.77 38.95 43.55 3.69	16.77 41.14 43.55 2.94	16.77 42.64 43.55 2.94	16.77 16.77 N/A 1.94	16.77 47.83 N/A 1.94	20.15 49.27 N/A 1.19	20.15 50.77 N/A 1.19		
4	AA❖ CA+ CB X	16.90 37.22 45.94 5.79	16.90 39.22 45.94 5.79	16.90 40.34 45.94 4.79	16.90 41.34 45.94 4.79	16.90 43.53 45.94 4.04	16.90 45.03 45.94 4.04	16.90 48.47 N/A 3.04	16.90 50.22 N/A 3.04	20.27 51.66 N/A 2.29	20.27 53.16 N/A 2.29	20.27 54.66 N/A 1.29	20.27 56.16 N/A 1.29

Δ 1-1/2" will clear breather on all size units.

❖ AA = Scoop width plus head thickness of mounting bolts.

+ Approx. overall length using squirrel cage, induction Reliance AC motor of the fan cooled type and DODGE couplings from page G3-55.

NOTE: Scoops are designed for standard size conduit boxes.

Upsize conduit boxes may interfere with side plates.

☐ Sizes 1-3 discontinued. Remaining stock may be available

FEATURES/BENEFITS PAGE G3-3	NOMENCLATURE PAGE G3-6	EASY SELECTION PAGE G3-7	RELATED PRODUCTS PAGE G3-55
--------------------------------	---------------------------	-----------------------------	--------------------------------



## MAXUM Concentric Reducer SCOOP MOUNT MOTOR/REDUCERS WITH AC MOTORS, SIZES 5-9 (WITHOUT EXTERNAL BACKSTOP)

MAXUM Size	A	B	C		D	E	F	G	H Bolts	J	K	N	NA	
			Double Red. Units	Triple Red. Units									Dbl. Red. Units w/o Fan	Triple red Units
5	18.63	12.00	29.14	28.05	9.96	8.20	10.00	1.25	1	4.19	1.00	6.75	4.51	3.42
6	21.38	13.81	31.44	30.36	11.66	9.30	11.30	1.38	1-1/8	4.50	1.25	7.50	4.51	3.42
7	25.49	18.50	39.06	37.64	14.80	11.22	14.70	1.80	1-1/4	7.06	1.90	8.05	5.41	3.77
9	31.50	22.00	47.39	45.70	18.13	13.44	18.19	2.19	1-1/2	10.00	1.89	10.67	6.25	4.23

MAXUM Size	O	Q	R	U		UA				Ave. Reducer Wt. (lbs.)
				Shaft dia.	Key Size	Double Reduction Units		Triple Reduction Units		
						Shaft Dia.	Key Size	Shaft Dia.	Key Size	
5	15.44	10.75	7.44	3.375	7/8 x 7/8 x 51/4	2.125	1/2 x 1/2 x 33/8	1.625	3/8 x 3/8 x 21/2	435
6	18.16	11.91	8.16	3.750	7/8 x 7/8 x 53/4	2.125	1/2 x 1/2 x 33/8	1.625	3/8 x 3/8 x 21/2	615
7	22.31	14.09	10.17	4.000	1 x 1 x 61/4	2.625	5/8 x 5/8 x 41/4	1.875	1/2 x 1/2 x 21/2	1200
9	27.38	17.49	11.94	5.250	1 1/4 x 1 1/4 x 813/16	3.000	3/4 x 3/4 x 47/8	2.125	1/2 x 1/2 x 33/8	2200

MAXUM Size	Dimensional Ref.	Red.	182T	184T	213T	215T	254T	256T	284T	286T	324T	326T	364T/365T	404T/405T	444T/445T
5	AA❖		24.67	24.67	24.67	24.67	24.67	24.67	24.67	24.67	24.67	24.67	24.67		
	CA+	DCR★ TCR■	44.01 42.92	45.01 43.92	47.20 46.11	48.70 47.61	52.14 51.05	53.89 52.80	55.33 54.24	56.83 55.74	58.33	59.83	62.83		
	CB	DCR★ TCR■	56.27 55.18	56.27 55.18	56.27 55.18	56.27 55.18	56.27 55.18	56.27 55.18	56.27 55.18	N/A N/A	N/A	N/A	N/A		
	X		5.01	5.01	4.26	4.26	3.26	3.26	2.51	2.51	1.51	1.51	0.51		
6	AA❖			24.67	24.67	24.67	24.67	24.67	24.67	24.67	24.67	24.67	24.67		
	CA+	DCR★ TCR■		47.31 46.23	49.50 48.42	51.00 49.92	54.44 53.36	56.19 55.11	57.63 56.55	59.13 58.05	60.63 59.55	62.13 61.05	65.13 64.05		
	CB	DCR★ TCR■		58.57 57.49	58.57 57.49	58.57 57.49	58.57 57.49	58.57 57.49	58.57 57.49	N/A N/A	N/A N/A	N/A N/A	N/A N/A		
	X			6.72	5.97	5.97	4.97	4.97	4.22	4.22	3.22	3.22	2.22		
7	AA❖				24.67	24.67	24.67	24.67	24.67	24.67	24.67	24.67	24.67	27.15	27.15
	CA+	DCR★ TCR■			57.12 55.70	58.62 57.20	62.06 60.64	63.81 62.39	65.25 63.83	66.75 65.33	68.25 66.83	69.75 68.33	72.75 71.33	77.62	83.93
	CB	DCR★ TCR■			65.68 64.26	65.68 64.26	65.68 64.26	65.68 64.26	66.19 64.77	N/A N/A	N/A N/A	N/A N/A	N/A N/A	N/A	N/A
	X				9.12	9.12	8.12	8.12	7.37	7.37	6.37	6.37	5.37	4.37	3.37
9	AA❖						34.65	34.65	34.65	34.65	34.65	34.65	34.65	34.65	34.65
	CA+	DCR★ TCR■					68.70	70.45	71.89	73.39	74.89	76.39	79.39	84.26	90.57
	CB	DCR★ TCR■					72.58	72.58	72.58	N/A	N/A	N/A	N/A	N/A	N/A
	X						11.82	11.82	11.07	11.07	10.07	10.07	9.07	8.07	7.07

- △ 1-1/2" will clear breather on all size units.
  - ◆ When using external backstops on sizes 7, 8 and 9, see page G3-37 for UA and NA dimensions.
  - ❖ AA = Scoop width plus head thickness of mounting bolts.
  - + Approx. overall length using squirrel cage, induction Reliance AC motor of the fan cooled type and DODGE couplings from page G3-55.
  - ★ Double Reduction reducer only.
  - Triple Reduction reducer only.
  - When using external backstops on sizes 7, 8 and 9, consult DODGE for scoop dimensions.
- NOTE:** Scoops are designed for standard size conduit boxes. Oversize conduit boxes may interfere with side plates.

FEATURES/BENEFITS PAGE G3-3	NOMENCLATURE PAGE G3-6	EASY SELECTION PAGE G3-7	RELATED PRODUCTS PAGE G3-55
--------------------------------	---------------------------	-----------------------------	--------------------------------

# MODIFICATIONS/ ACCESSORIES



## MAXUM Concentric Reducer

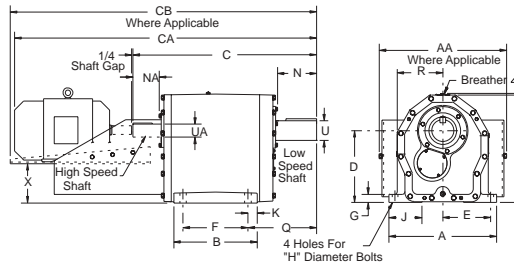

### SCOOP MOUNT MOTOR/REDUCER WITH AC MOTORS, SIZES 10 - 12 (WITHOUT EXTERNAL BACKSTOP)

MAXUM Size	A	B	C		D	E	F	G	H Bolts	J	K	N	NA ♦		
			Ratios 5.06-70.62	Ratios 86.50-194.6									Dbl. Red. Units w/o Fan	Triple Red Units 31.39-70.62	86.50-194.6
10	29.93	24.00	48.20	47.09	18.38	13.10	20.25	2.25	1-1/2	9.00	1.87	11.00	6.31	5.90	4.78
11	33.02	24.25	49.84	48.65	20.75	14.44	20.38	2.50	1-3/4	9.00	1.94	11.51	5.33	5.37	4.18
12	34.46	24.88	50.41	49.22	23.38	15.20	21.00	2.75	1-3/4	9.00	1.94	12.00	5.33	5.37	4.18

MAXUM Size	O	Q	R	U		UA ♦				Avg. Reducer Wt. (Lbs.)
				Shaft Dia.	Key Size	Dbl. Reduction Units		Triple Reduction Units		
						Shaft Dia.	Key Size	Shaft Dia.	Key Size ▲	
10	28.43	16.67	12.76	6.00	1-1/2 x 1-1/2 x 8-3/4	3.500	7/8 x 7/8 x 4-7/8	2.375	5/8 x 5/8 x 3-3/4	2485
11	32.11	17.93	14.54	6.50	1-1/2 x 1-1/2 x 9-1/4	3.750	7/8 x 7/8 x 4-1/2	2.375	5/8 x 5/8 x 3-3/4	3320
12	35.79	18.17	16.18	7.00	1-3/4 x 1-3/4 x 9-5/32	3.750	7/8 x 7/8 x 4-1/2	2.375	5/8 x 5/8 x 3-3/4	4100

MAXUM Size	Dimensional Ref.	Red.	256T	284T	286T	324T	326T	364T	365T	404T	405T	444T/445T
10	AA❖		34.65	34.65	34.65	34.65	34.65	34.65	34.65	34.65	34.65	34.65
	CA+●	DCR★ TCR■	72.97	74.41	75.91	77.41	78.91	81.91	81.91	86.78	86.78	93.07 93.09
	CBD	TCR■	75.42	75.42	N/A	N/A	N/A	N/A	N/A	N/A	N/A	N/A
	X		11.69	10.94	10.94	9.94	9.94	8.94	8.94	7.94	7.94	6.94
11	AA❖			34.65	34.65	34.65	34.65	34.65	34.65	34.65	34.65	34.65
	CA+●	DCR★ TCR■		76.03	77.53	79.03	80.53	83.53	83.53	88.40	88.40	94.71
	CBD	TCR■		76.97	N/A	N/A	N/A	N/A	N/A	N/A	N/A	N/A
	X			13.32	13.32	12.32	12.32	11.32	11.32	10.32	10.32	9.32
12	AA❖			34.65	34.65	34.65	34.65	34.65	34.65	34.65	34.65	34.65
	CA+●	DCR★ TCR■		76.60	78.10	79.60	81.10	84.10	84.10	88.97	88.97	95.28
	CB●	DCR★		N/A	N/A	N/A	N/A	N/A	N/A	N/A	N/A	N/A
	X			15.94	15.94	14.94	14.94	13.94	13.94	12.94	12.94	11.94

- △ 1-1/2, will clear breather on all size units.
  - ❖ AA = Scoop width plus head thickness of mounting bolts.
  - + Approx. overall length using squirrel cage, induction Reliance AC motor of the fan cooled type and DODGE couplings from page G3-55.
  - ▲ On ratios 31.39-70.62 key length is 4-15/16.
  - ★ Double Reduction reducer only.
  - ♦ When using external backstops on sizes 10, 11 and 12, see page G3-37 for UA and NA dimensions.
  - Triple Reduction reducer only.
  - On ratios 86.50-194.6, dimension CA will be approximately 1.25" shorter. When using external backstops, consult DODGE for scoop dimensions.
- NOTE:** Scoops are designed for standard size conduit boxes. Oversize conduit boxes may interfere with side plates.

FEATURES/BENEFITS PAGE G3-3	NOMENCLATURE PAGE G3-6	EASY SELECTION PAGE G3-7	RELATED PRODUCTS PAGE G3-55
--------------------------------	---------------------------	-----------------------------	--------------------------------



## MAXUM Concentric Reducer

### COUPLING GUARDS

MAXUM coupling guards, made of fabricated steel, are available for use with MAXUM Concentric Shaft Scoop/Motor/Reducers sizes 1-12 and are supplied as part of scoop or baseplate package unless specified otherwise. They offer positive protection from objects falling into the rotating coupling.

When considering other combinations or non-DODGE couplings, consult DODGE.

**NOTE: Coupling guards are designed for use on reducers without backstops.**

### COUPLING GUARD PART NUMBERS ■

GUARD NUMBER	PART NUMBER	MAXUM CASE SIZE	MOTOR FRAMES
1	299451	DCR/TCR 1 & 2	140-210T
2	299452	DCR 2	250T
3	299453	DCR/TCR 3 & 4 TCR 5 & 6	140-210T
4	299454	DCR/TCR 3 & 4 TCR 5 & 6	250-280T
5	299455	DCR 4, TCR 6	320T
6	299456	TCR 6	360T
7	299457	DCR 5 & 6	180-250T
8	299458	DCR 5 & 6	280-360T
11	299461	TCR 7	210-250T
12	299462	TCR 7 DCR 7	280-360T 250T
14	299464	DCR 7	280-360T
15	304938	DCR 7	400T
16	304939	DCR 7	440T
17	299467	TCR 9	250-280T
18	299468	TCR 9	320-360T
19	299469	TCR 9	400T
20	299470	TCR 9	440T
21	299471	DCR 9	360T
22	304940	DCR 9	400T
23	304941	DCR 9	440T
24	299474	TCR 10	250-280T
25	299475	TCR 10	320-360T
26	299476	TCR 10 ▲	400T
27	299477	TCR 10 ▲	440T
28	304942	DCR/TCR 10 ★	400T
29	304943	DCR/TCR 10 ★	440T
30	299480	TCR 11 & 12	280-360T
31	299481	TCR 11 & 12 ▲	400T
32	299482	TCR 11 & 12 ▲	440T
33	304947	DCR/TCR 11 & 12 ★	400T
34	304950	DCR/TCR 11 & 12 ★	440T
35	304936	DCR 10, 11 & 12	360T

‡ Refers to maximum size coupling that guard is designed to cover. Actual coupling supplied by DODGE in scoop or baseplate package may be a smaller size.

★ Triple reduction ratios 31.39-70.62.

▲ Triple reduction ratios 86.50-194.6.

■ Refer to Table 12, page G3-34 for compatibility of various combinations of reducers and accessories. See pages G3-55 and G3-56 for listing of coupling sizes.

■ Sizes 1-3 discontinued. Remaining stock may be available



### Motor Mtg. Hardware Kit

AC Motor Frame Size	Ordering Number †	Description †
140T	014524	5/6" Bolts Kit
180T, 210T	014525	3/8" Bolts Kit
250T, 280T	014526	1/2" Bolts Kit
320T, 360T	014527	5/8" Bolts Kit
400T, 440T	014528	3/4" Bolts Kit

† Bolt Kits include bolts and shims for mounting motor to scoop

FEATURES/BENEFITS PAGE G3-3	NOMENCLATURE PAGE G3-6	EASY SELECTION PAGE G3-7	RELATED PRODUCTS PAGE G3-55
--------------------------------	---------------------------	-----------------------------	--------------------------------

# MODIFICATIONS/ ACCESSORIES



## MAXUM Concentric Reducer

### SCOOP PACKAGES WITH PARA-FLEX COUPLINGS ■ ◆

MAXUM Size	Scoop Package Part Number	Side Plate	Bottom Plate	Motor Mounting Bolt Kit	Coupling Element	Quantity (2) Coupling Flange	Reducer Bushing	Motor Bushing	Coupling Guard Assembly	Scoop Package Weight (lbs.)
1	DCS01140P	299501	299589	014524	011106	010602	119404	119396	299451	60.2
1	DCS01180P	299501	299589	014525	011106	010602	119404	119400	299451	60.2
1	DCS01210P	299501	299589	014525	011106	010602	119404	119404	299451	60.2
1	TCS01140P	299501	299589	014524	011106	010602	119404	119396	299451	60.2
1	TCS01180P	299501	299589	014525	011106	010602	119404	119400	299451	60.2
2	DCS02140P	299502	299590	014524	011106	010602	119404	119396	299451	101.2
2	DCS02180P	299502	299590	014525	011106	010602	119404	119400	299451	101.2
2	DCS02210P	299502	299590	014525	011106	010602	119404	119404	299451	101.2
2	DCS02250P	299502	299590	014526	011107	010603	119225	119229	299452	116.0
2	TCS02140P	299502	299590	014524	011106	010602	119404	119396	299451	101.2
2	TCS02180P	299502	299590	014525	011106	010602	119404	119400	299451	101.2
2	TCS02210P	299502	299590	014525	011106	010602	119404	119404	299451	101.2
3	DCS03140P	299503	299590	014524	011106	(1)	009212	009208	299453	110.6
3	DCS03180P	299503	299590	014525	011107	010603	119229	119221	299453	120.0
3	DCS03210P	299503	299590	014525	011107	010603	119229	119225	299453	120.0
3	DCS03250P	299503	299590	014526	011107	010603	119229	119229	299454	125.0
3	DCS03280P	299503	299591	014526	011108	010604	117092	117095	299454	148.6
3	TCS03140P	299503	299590	014524	011106	(1)	009212	000590	299453	110.6
3	TCS03180P	299503	299590	014525	011107	010603	000598	119221	299453	120.0
3	TCS03210P	299503	299590	014525	011107	010603	119229	119225	299453	120.0
3	TCS03250P	299503	299590	014526	011107	010603	119229	119229	299454	125.0
4	DCS04140P	299504	299590	014524	011106	(1)	009212	009208	299453	135.4
4	DCS04180P	299504	299590	014525	011107	010603	119229	119221	299453	138.0
4	DCS04210P	299504	299590	014525	011107	010603	119229	119225	299453	138.0
4	DCS04250P	299504	299590	014526	011107	010603	119229	119229	299454	143.0
4	DCS04280P	299504	299591	014526	011108	010604	117092	117095	299454	166.6
4	DCS04320P	299504	299591	014527	011108	010604	117092	117177	299455	173.6
4	TCS04140P	299504	299590	014524	011106	(1)	009212	009208	299453	135.4
4	TCS04180P	299504	299590	014525	011107	010603	119229	119221	299453	138.0
4	TCS04210P	299504	299590	014525	011107	010603	119229	119225	299453	138.0
4	TCS04250P	299504	299590	014526	011107	010603	119229	119229	299454	143.0
4	TCS04280P	299504	299591	014526	011108	010604	117092	117095	299454	166.6
5	DCS05210P	299505	299592	014525	011108	010604	117177	117091	299454	186.6
5	DCS05250P	299505	299592	014526	011108	010604	117177	117092	299457	186.6
5	DCS05280P	299505	299592	014526	011108	010604	117177	117095	299458	194.6
5	DCS05320P	299505	299592	014527	011108	010604	117177	117177	299458	194.6
5	DCS05360P	299505	299592	014527	011109	010605	119126	117098	299458	203.8
5	TCS05140P	299505	299592	014524	011106	(1)	009212	009208	299453	165.0
5	TCS05180P	299505	299592	014525	011107	010603	119229	119221	299453	174.0
5	TCS05210P	299505	299592	014525	011107	010603	119229	119225	299453	174.0
5	TCS05250P	299505	299592	014526	011107	010603	119229	119229	299454	179.0
5	TCS05280P	299505	299592	014526	011108	010604	117092	117095	299454	185.6
6	DCS06210P	299506	299592	014525	011108	010604	117177	117091	299457	197.6
6	DCS06250P	299506	299592	014526	011108	010604	117177	117092	299457	197.6
6	DCS06280P	299506	299592	014526	011108	010604	117177	117095	299458	205.6
6	DCS06320P	299506	299592	014527	011108	010604	117177	117177	299458	205.6
6	DCS06360P	299506	299592	014527	011109	010605	119126	117098	299458	214.8
6	TCS06180P	299506	299592	014525	011107	010603	119229	119221	299453	185.0

(1) Finished Bore PARA-FLEX Coupling. Part numbers listed in bushing columns are for the PX60FB hubs required to make a complete coupling.

■ Refer to Table 12, page G3-34 for compatibility of various combinations of reducers and accessories.

◆ When using external backstops on sizes 7 through 12 reducers with scoops, see page G3-37 for UA and NA dimensions. Change out TL Bushing or Finish bore hub to fit smaller input shaft diameter of backstop reducer.

■ Sizes 1-3 discontinued. Remaining stock may be available.

FEATURES/BENEFITS PAGE G3-3	NOMENCLATURE PAGE G3-6	EASY SELECTION PAGE G3-7	RELATED PRODUCTS PAGE G3-55
--------------------------------	---------------------------	-----------------------------	--------------------------------



## MAXUM Concentric Reducer

### SCOOP PACKAGES WITH PARA-FLEX COUPLINGS ■ ◆

MAXUM Size	Scoop Package Part Number	Side Plate	Bottom Plate	Motor Mounting Bolt Kit	Coupling Element	Quantity (2) Coupling Flange	Reducer Bushing	Motor Bushing	Coupling Guard Assembly	Scoop Package Weight (lbs.)
6	TCS06210P	299506	299592	014525	011107	010603	119229	119225	299453	185.0
6	TCS06250P	299506	299592	014526	011107	010603	119229	119229	299454	190.0
6	TCS06280P	299506	299592	014526	011108	010604	117092	117095	299454	196.6
6	TCS06320P	299506	299592	014527	011108	010604	117092	117177	299455	203.6
6	TCS06360P	299506	299592	014527	011109	010605	119144	117098	299456	217.8
7	DCS07250P	299507	299592	014526	011109	010605	117111	119144	299462	252.8
7	DCS07280P	299507	299592	014526	011109	010605	117111	119122	299464	252.8
7	DCS07320P	299507	299592	014527	011109	010605	117111	119126	299464	252.8
7	DCS07360P	299507	299592	014527	011109	010605	117111	117098	299464	252.8
7	DCS07400P	299507	299593	014528	011112	010608	117128	117132	304938	356.4
7	DCS07440P	299507	299593	014528	011114	011134	117224	117233	304939	436.0
7	TCS07210P	299507	299592	014525	011108	010604	117095	117091	299461	229.6
7	TCS07250P	299507	299592	014526	011108	010604	117095	117092	299461	229.6
7	TCS07280P	299507	299592	014526	011108	010604	117095	117095	299462	242.6
7	TCS07320P	299507	299592	014527	011108	010604	117095	117177	299462	242.6
7	TCS07360P	299507	299592	014527	011109	010605	119122	117098	299462	251.8
9	DCS09360P	299509	299594	014527	011112	010608	117134	117124	299471	362.4
9	DCS09400P	299509	299595	014528	011112	010608	117134	117132	304940	417.4
9	DCS09440P	299509	299595	014528	011114	011134	117229	117233	304941	500.0
9	TCS09250P	299509	299594	014526	011108	010604	117177	117092	299467	293.6
9	TCS09280P	299509	299594	014526	011108	010604	117177	117095	299467	293.6
9	TCS09320P	299509	299594	014527	011108	010604	117177	117177	299468	304.6
9	TCS09360P	299509	299594	014527	011109	010605	119126	117098	299468	313.8
9	TCS09400P	299509	299595	014528	011112	010608	117120	117132	299469	415.4
9	TCS09440P	299509	299595	014528	011114	011134	117218	117233	299470	498.0
10	DCS10360P	299510	299594	014527	011114	011134	117235	117221	304936	467.0
10	DCS10400P	299510	299595	014528	011114	011134	117235	117227	304942	509.0
10	DCS10440P	299510	299595	014528	011114	011134	117235	117233	304943	518.0
10	TCS10250P	299510	299594	014526	011109	010605	117098	119144	299474	316.8
10	TCS10280P	299510	299594	014526	011109	010605	117098	119122	299474	316.8
10	TCS10320P	299510	299594	014527	011109	010605	117098	119126	299475	335.8
10	TCS10360P	299510	299594	014527	011109	010605	117098	117098	299475	335.8
10	TCS10400P	299510	299595	014528	011112	010608	117124	117132	299476	432.4
10	TCS10440P	299510	299595	014528	011114	011134	117221	117233	299477	518.0
11	DCS11360P	299511	299594	014527	011114	011134	117709	117221	304936	490.0
11	DCS11400P	299511	299595	014528	011114	011134	117709	117227	304947	537.0
11	DCS11440P	299511	299595	014528	011114	011134	117709	117233	304950	550.0
11	TCS11280P	299511	299594	014526	011109	010605	117098	119122	299480	363.8
11	TCS11320P	299511	299594	014527	011109	010605	117098	119126	299480	363.8
11	TCS11360P	299511	299594	014527	011109	010605	117098	117098	299480	363.8
11	TCS11400P	299511	299595	014528	011112	010608	117124	117132	299481	458.4
11	TCS11440P	299511	299595	014528	011114	011134	117221	117233	299482	544.0
12	DCS12360P	299512	299594	014527	011114	011134	117709	117221	304936	505.0
12	DCS12400P	299512	299595	014528	011114	011134	117709	117227	299481	552.0
12	DCS12440P	299512	299595	014528	011114	011134	117709	117233	304950	565.0
12	TCS12280P	299512	299594	014526	011109	010605	117098	119122	299480	378.8
12	TCS12320P	299512	299594	014527	011109	010605	117098	119126	299480	378.8
12	TCS12360P	299512	299594	014527	011109	010605	117098	117098	299480	378.8
12	TCS12400P	299512	299595	014528	011112	010608	117124	117132	299481	473.4
12	TCS12440P	299512	299595	014528	011114	011134	117221	117233	299482	559.0

■ Refer to Table 12, page G3-34 for compatibility of various combinations of reducers and accessories.

◆ When using external backstops on sizes 7 through 12 reducers with scoops, see page G3-37 for UA and NA dimensions. Change out TL Bushing or Finish bore hub to fit smaller input shaft diameter of backstop reducer.

FEATURES/BENEFITS PAGE G3-3	NOMENCLATURE PAGE G3-6	EASY SELECTION PAGE G3-7	RELATED PRODUCTS PAGE G3-55
--------------------------------	---------------------------	-----------------------------	--------------------------------

# MODIFICATIONS/ ACCESSORIES



## MAXUM Concentric Reducer SCOOP PACKAGES WITH GRID-LIGN COUPLINGS ■ ◆

MAXUM Size	Scoop Package Part Number	Side Plate	Bottom Plate	Motor Mounting Bolt Kit	Grid & Cover Assembly	Reducer Hub	Motor Hub	Coupling Guard Assy.	Scoop Package Weight (lbs.)
1	DCS01140G	299501	299589	014524	006751	006591	006587	299451	56.5
1	DCS01180G	299501	299589	014525	006751	006591	006589	299451	56.5
1	DCS01210G	299501	299589	014525	006751	006591	006591	299451	56.5
1	TCS01140G	299501	299589	014524	006751	006591	006587	299451	56.5
1	TCS01180G	299501	299589	014525	006751	006591	006589	299451	56.5
2	DCS02140G	299502	299590	014524	006751	006591	006587	299451	97.5
2	DCS02180G	299502	299590	014525	006751	006591	006589	299451	97.5
2	DCS02210G	299502	299590	014525	006751	006591	006591	299451	97.5
2	DCS02250G	299502	299590	014526	006752	006596	006598	299452	110.0
2	TCS02140G	299502	299590	014524	006751	006591	006587	299451	97.5
2	TCS02180G	299502	299590	014525	006751	006591	006589	299451	97.5
2	TCS02210G	299502	299590	014525	006751	006591	006591	299451	97.5
3	DCS03140G	299503	299590	014524	006752	006598	006592	299453	114.0
3	DCS03180G	299503	299590	014525	006752	006598	006594	299453	114.0
3	DCS03210G	299503	299590	014525	006752	006598	006596	299453	114.0
3	DCS03250G	299503	299590	014526	006752	006598	006598	299454	119.0
3	DCS03280G	299503	299591	014526	006753	006603	006605	299454	140.0
3	TCS03140G	299503	299590	014524	006752	006598	006592	299453	114.0
3	TCS03180G	299503	299590	014525	006752	006598	006594	299453	114.0
3	TCS03210G	299503	299590	014525	006752	006598	006596	299453	114.0
3	TCS03250G	299503	299590	014526	006752	006598	006598	299454	119.0
4	DCS04140G	299504	299590	014524	006752	006598	006592	299453	132.0
4	DCS04180G	299504	299590	014525	006752	006598	006594	299453	132.0
4	DCS04210G	299504	299590	014525	006752	006598	006596	299453	132.0
4	DCS04250G	299504	299590	014526	006752	006598	006598	299454	137.0
4	DCS04280G	299504	299591	014526	006753	006603	006605	299454	158.0
4	DCS04320G	299504	299591	014527	006754	006608	006611	299455	169.5
4	TCS04140G	299504	299590	014524	006752	006598	006592	299453	132.0
4	TCS04180G	299504	299590	014525	006752	006598	006594	299453	132.0
4	TCS04210G	299504	299590	014525	006752	006598	006596	299453	132.0
4	TCS04250G	299504	299590	014526	006752	006598	006598	299454	137.0
4	TCS04280G	299504	299591	014526	006753	006603	006605	299454	158.0
5	DCS05210G	299505	299592	014525	006754	006611	006606	299454	182.5
5	DCS05250G	299505	299592	014526	006754	006611	006608	299457	182.5
5	DCS05280G	299505	299592	014526	006754	006611	006610	299458	190.5
5	DCS05320G	299505	299592	014527	006754	006611	006611	299458	190.5
5	DCS05360G	299505	299592	014527	006755	006616	006618	299458	197.0
5	TCS05140G	299505	299592	014524	006752	006598	006592	299453	168.0
5	TCS05180G	299505	299592	014525	006752	006598	006594	299453	168.0
5	TCS05210G	299505	299592	014525	006752	006598	006596	299453	168.0
5	TCS05250G	299505	299592	014526	006752	006598	006598	299454	173.0
5	TCS05280G	299505	299592	014526	006753	006603	006605	299454	177.0
6	DCS06210G	299506	299592	014525	006754	006611	006606	299457	200.0
6	DCS06250G	299506	299592	014526	006754	006611	006608	299457	200.0
6	DCS06280G	299506	299592	014526	006754	006611	006610	299458	208.0
6	DCS06320G	299506	299592	014527	006754	006611	006611	299458	208.0
6	DCS06360G	299506	299592	014527	006755	006616	006618	299458	208.0
6	TCS06180G	299506	299592	014525	006752	006598	006594	299453	179.0

■ Refer to Table 12, page G3-34 for compatibility of various combinations of reducers and accessories.

◆ When using external backstops on sizes 7 through 12 reducers with scoops, see page G3-37 for UA and NA dimensions. Change out TL Bushing or Finish bore hub to fit smaller input shaft diameter of backstop reducer.

■ Sizes 1-3 discontinued. Remaining stock may be available.

FEATURES/BENEFITS  
PAGE G3-3

NOMENCLATURE  
PAGE G3-6

EASY SELECTION  
PAGE G3-7

RELATED PRODUCTS  
PAGE G3-55

# MODIFICATIONS/ ACCESSORIES



Gearing Reference Guide

TORQUE-ARM II

TORQUE-ARM

MAXUM Concentric Reducer

TIGEAR-2

## MAXUM Concentric Reducer SCOOP PACKAGES WITH GRID-LIGN COUPLINGS ■ ◆

MAXUM Size	Scoop Package Part Number	Side Plate	Bottom Plate	Motor Mounting Bolt Kit	Grid & Cover Assembly	Reducer Hub	Motor Hub	Coupling Guard Assy.	Scoop Package Weight (lbs.)
6	TCS06210G	299506	299592	014525	006752	006598	006596	299453	179.0
6	TCS06250G	299506	299592	014526	006752	006598	006598	299454	184.0
6	TCS06280G	299506	299592	014526	006753	006603	006605	299454	188.0
6	TCS06320G	299506	299592	014527	006754	006608	006611	299455	199.5
6	TCS06360G	299506	299592	014527	006755	006612	006618	299456	211.0
7	DCS07250G	299507	299592	014526	006755	006479	006612	299462	246.0
7	DCS07280G	299507	299592	014526	006755	006479	006614	299464	246.0
7	DCS07320G	299507	299592	014527	006755	006479	006616	299464	246.0
7	DCS07360G	299507	299592	014527	006755	006479	006618	299464	246.0
7	DCS07400G	299507	299593	014528	006756	006625	006627	304938	321.0
7	DCS07440G	299507	299593	014528	006757	006796	006802	304939	341.0
7	TCS07210G	299507	299592	014525	006753	006605	006601	299461	221.0
7	TCS07250G	299507	299592	014526	006753	006605	006603	299461	221.0
7	TCS07280G	299507	299592	014526	006753	006605	006605	299462	234.0
7	TCS07320G	299507	299592	014527	006754	006610	006611	299462	239.0
7	TCS07360G	299507	299592	014527	006755	006614	006618	299462	245.0
9	DCS09360G	299509	299594	014527	006756	006628	006623	299471	327.0
9	DCS09400G	299509	299595	014528	006756	006628	006627	304940	382.0
9	DCS09440G	299509	299595	014528	006757	006799	006802	304941	405.0
9	TCS09250G	299509	299594	014526	006754	006611	006608	299467	290.0
9	TCS09280G	299509	299594	014526	006754	006611	006610	299467	290.0
9	TCS09320G	299509	299594	014527	006754	006611	006611	299468	301.0
9	TCS09360G	299509	299594	014527	006755	006616	006618	299468	307.0
9	TCS09400G	299509	299595	014528	006756	006621	006627	299469	380.0
9	TCS09440G	299509	299595	014528	006757	006656	006802	299470	403.0
10	DCS10360G	299510	299594	014527	006757	006803	006804	304936	371.5
10	DCS10400G	299510	299595	014528	006757	006803	006798	304942	413.5
10	DCS10440G	299510	299595	014528	006757	006803	006802	304943	422.5
10	TCS10250G	299510	299594	014526	006755	006618	006612	299474	310.0
10	TCS10280G	299510	299594	014526	006755	006618	006614	299474	310.0
10	TCS10320G	299510	299594	014527	006755	006618	006616	299475	329.0
10	TCS10360G	299510	299594	014527	006755	006618	006618	299475	329.0
10	TCS10400G	299510	299595	014528	006756	006623	006627	299476	397.0
10	TCS10440G	299510	299595	014528	006757	006804	006802	299477	422.5
11	DCS11360G	299511	299594	014527	006757	006480	006804	304936	394.5
11	DCS11400G	299511	299595	014528	006757	006480	006798	304947	441.5
11	DCS11440G	299511	299595	014528	006757	006480	006802	304950	454.5
11	TCS11280G	299511	299594	014526	006755	006618	006614	299480	357.0
11	TCS11320G	299511	299594	014527	006755	006618	006616	299480	357.0
11	TCS11360G	299511	299594	014527	006755	006618	006618	299480	357.0
11	TCS11400G	299511	299595	014528	006756	006623	006627	299481	423.0
11	TCS11440G	299511	299595	014528	006757	006804	006802	299482	448.5
12	DCS12360G	299512	299594	014527	006757	006480	006804	304936	409.5
12	DCS12400G	299512	299595	014528	006757	006480	006798	299481	456.5
12	DCS12440G	299512	299595	014528	006757	006480	006802	304950	469.5
12	TCS12280G	299512	299594	014526	006755	006618	006614	299480	372.0
12	TCS12320G	299512	299594	014527	006755	006618	006616	299480	372.0
12	TCS12360G	299512	299594	014527	006755	006618	006618	299480	372.0
12	TCS12400G	299512	299595	014528	006756	006623	006627	299481	438.0
12	TCS12440G	299512	299595	014528	006757	006804	006802	299482	463.5

- Refer to Table 12, page G3-34 for compatibility of various combinations of reducers and accessories.
- ◆ When using external backstops on sizes 7 through 12 reducers with scoops, see page G3-37 for UA and NA dimensions. Change out TL Bushing or Finish bore hub to fit smaller input shaft diameter of backstop reducer.

FEATURES/BENEFITS PAGE G3-3	NOMENCLATURE PAGE G3-6	EASY SELECTION PAGE G3-7	RELATED PRODUCTS PAGE G3-55
--------------------------------	---------------------------	-----------------------------	--------------------------------

# MODIFICATIONS/ ACCESSORIES



## MAXUM Concentric Reducer

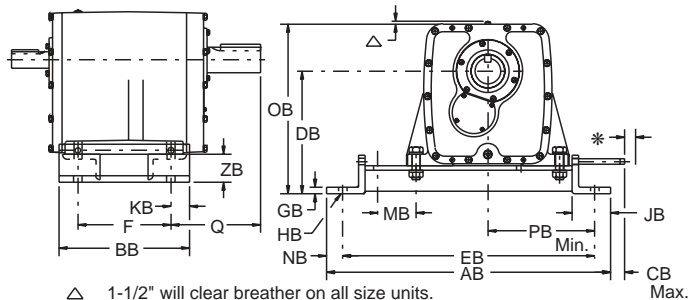

△ 1-1/2" will clear breather on all size units.

\* Minimum distance required to remove adjusting stud.



### SLIDE BASES

The MAXUM Reducer Slide Base positions the reducer, providing simplified installation and servicing of belt and chain drives. When a change in reducer position is desired, simply loosen reducer hold-down bolts and slide reducer

by using the adjusting screw provided. After desired belt or chain tension has been obtained, retighten reducer bolts and unit is ready to operate.

**NOTE:** For Slide Bases for MAXUM HD Baseplates, consult DODGE.

### MAXUM REDUCER SLID BASES ■

Reducer Size	Part Numbers	AB	BB	CBG	DB	ED	F	GB	HB Bolts	JB
1	304627	23.25	9.00	2.88	9.05	21.25	6.00	0.50	1/2"	3.00
2	304628	24.25	10.25	2.97	9.75	22.25	7.13	0.50	5/8"	3.00
3	304629	26.75	11.25	2.97	11.25	24.75	7.75	0.50	3/4"	3.00
4	304630	30.88	13.25	3.11	14.10	28.13	9.00	0.75	7/8"	4.00
5	304631	32.63	13.75	3.11	14.46	29.88	10.00	0.75	1"	4.00
6	304632	35.38	15.50	3.22	16.16	32.63	11.30	0.75	1-1/8"	4.00
7	304633	44.44	20.50	2.25	19.18	39.44	14.70	1.00	11/4"	6.00
9	304635	50.38	24.00	2.25	22.50	45.38	18.19	1.00	11/2"	6.00
10	304636	49.94	26.00	3.34	24.63	44.94	20.25	1.00	11/2"	6.00
11	304637	53.31	26.25	3.34	27.00	48.31	20.38	1.00	13/4"	6.00
12	304638	56.16	26.88	3.34	29.63	51.16	21.00	1.00	13/4"	6.00

Reducer Size	KB	MB	NB	OB	PB Min.	Q	ZB	★	Wt. (lbs.)
1	1.50	4.50	1.00	12.89	8.36	6.72	2.75	3/4"	45
2	1.56	4.50	1.00	13.75	8.85	7.46	2.75	3/4"	48
3	1.75	4.50	1.00	16.13	10.10	8.78	2.75	3/4"	54
4	2.13	5.00	1.38	18.97	11.55	9.45	4.50	1"	95
5	1.88	5.00	1.38	19.94	12.42	10.75	4.50	1"	100
6	2.09	5.00	1.38	22.66	13.80	11.91	4.50	1"	112
7	2.88	6.00	2.50	26.69	16.72	14.09	4.38	11/4"	245
9	2.91	6.00	2.50	31.76	19.69	17.49	4.38	11/4"	300
10	2.88	7.00	2.50	34.68	18.94	16.67	6.25	11/4"	370
11	2.94	7.00	2.50	38.36	20.66	17.93	6.25	11/4"	380
12	2.94	7.00	2.50	42.04	22.08	18.17	6.25	11/4"	410

■ Refer to Table 12, page G3-34 for compatibility of various combinations of reducers and accessories.

■ Sizes 1-3 discontinued. Remaining stock may be available.

FEATURES/BENEFITS PAGE G3-3	NOMENCLATURE PAGE G3-6	EASY SELECTION PAGE G3-7	RELATED PRODUCTS PAGE G3-55
--------------------------------	---------------------------	-----------------------------	--------------------------------



## MAXUM Concentric Reducer

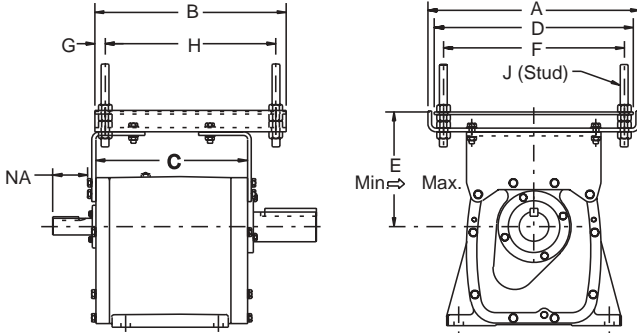

### TOP MOTOR MOUNTS

The MAXUM Motor Mount is a rugged all steel unit which requires no drilling or foundation. It bolts directly to the top of the MAXUM Concentric Shaft Reducer. Each mount

accommodates a wide variety of NEMA AC motor frames. For initial belt installation the adjusting screws can be set at a minimum position which offers adequate future V-belt adjustment.

### TOP MOTOR MOUNTS SIZES 1-6 ■

Motor Mount Size	Motor Mount Part Number	Wt.	MAXUM Size	To Accommodate NEMA Motor Frame Sizes ★	A	B	C Nom.	D	E ▲	
									Min	Max
MAXUM 1-2	299529	80	1	143 thru 215	18.63	17.00	10.62	17.50	9.27	12.86
			2	143 thru 256			11.90		9.45	13.04
MAXUM 3-4	299530	107	3	143 thru 286	20.50	18.50	12.77	19.25	9.89	13.60
			4	143 thru 326			14.67		9.77	13.48
MAXUM 5-6	299531	149	5	182 thru 365	22.50	19.00	16.20	21.25	10.78	15.73
			6	182 thru 365			17.77		11.78	16.73

Motor Mount Size	F	G	H	J-Stud		NA	
				Dia.	Lgth.	Double	Triple
MAXUM 1-2	15.50	1.00	14.25	3/4-10	8	3.05	3.05
MAXUM 3-4	17.50	1.00	16.50	3/4-10	8	3.37	3.37
MAXUM 5-6	19.25	1.13	16.50	1-8	9	4.50	3.41

★ Select motor size to suit horsepower requirements. See table below for V-belt center distances.

▲ Provides for V-belt adjustment.

### V-BELT CENTER DISTANCES FOR MAXUM MOTOR MOUNTS

Motor Mount Size	MAXUM Size	Center Distances for NEMA Motor Mounts													
		140		180		210		250		280		320		360	
		Min.	Max.	Min.	Max.	Min.	Max.	Min.	Max.	Min.	Max.	Min.	Max.	Min.	Max.
MAXUM 1-2	1	13.27	16.36	14.27	17.36	15.02	18.11								
	2	13.45	16.54	14.45	17.54	15.20	18.29	16.20	19.29						
MAXUM 3-4	3	13.89	17.10	14.89	18.10	15.64	18.85	16.64	19.85	17.39	20.60				
	4	13.77	16.98	14.77	17.98	15.52	18.73	16.52	19.73	17.27	20.48	18.27	21.48		
MAXUM 5-6	5			15.78	20.23	16.53	20.98	17.53	21.98	18.28	22.73	19.28	23.73	20.28	24.73
	6			16.78	21.23	17.53	21.98	18.53	22.98	19.28	23.73	20.28	24.73	21.28	25.73

■ Refer to Table 12, page G3-34 for compatibility of various combinations of reducers and accessories.

■ Sizes 1-3 discontinued. Remaining stock may be available

FEATURES/BENEFITS PAGE G3-3	NOMENCLATURE PAGE G3-6	EASY SELECTION PAGE G3-7	RELATED PRODUCTS PAGE G3-55
--------------------------------	---------------------------	-----------------------------	--------------------------------

# MODIFICATIONS/ ACCESSORIES



## MAXUM Concentric Reducer

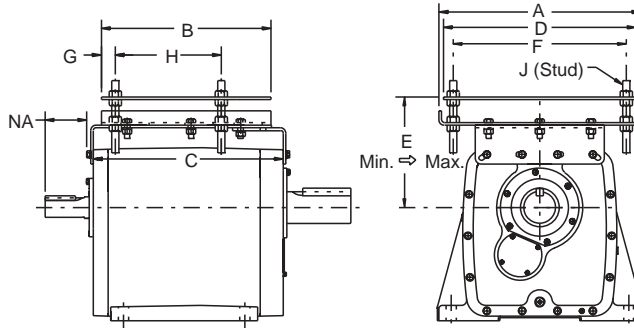

### TOP MOTOR MOUNTS SIZES 7-12 ■

Motor Mount Size	Motor Mount Part Number	Wt.	MAXUM Size	To Accommodate NEMA Motor Frame Sizes ★	A	B	C Nom.	D	E ▲	
									Min	Max
MAXUM 7	299532	257	7	213 thru 445	28.50	24.00	23.69	27.25	13.41	18.91
MAXUM 9	299534	278	9	213 thru 445	28.50	24.00	28.45	27.25	15.53	21.03
MAXUM 10	299535	283	10	254 thru 445	28.50	24.00	28.82	27.25	16.59	22.09
MAXUM 11	299536	289	11	284 thru 445	28.50	24.00	30.51	27.25	19.37	24.87
MAXUM 12	299537	301	12	284 thru 445	28.50	24.00	30.57	27.25	20.37	25.87

Motor Mount Size	F	G	H	J-Stud		NA		
				Dia.	Lgth.	Double	Triple	
							31.39-70.62	86.50-194.6
MAXUM 7	24.25	2.00	15.00	1-8	101/4	5.41	3.77	3.77
MAXUM 9	24.25	2.00	15.00	1-8	101/4	6.15	4.23	4.23
MAXUM 10	24.25	2.00	15.00	1-8	101/4	6.23	5.90	4.78
MAXUM 11	24.25	2.00	15.00	1-8	101/4	5.33	5.37	4.18
MAXUM 12	24.25	2.00	15.00	1-8	101/4	5.33	5.37	4.18

★ Select motor size to suit horsepower requirements. See table below for V-belt center distances.  
▲ Provides for V-belt adjustment.

### V-BELT CENTER DISTANCES FOR MAXUM MOTOR MOUNTS

Motor Mount Size	MAXUM Size	Center Distances for NEMA Motor Mounts													
		210		250		280		320		360		400		440	
		Min.	Max.	Min.	Max.	Min.	Max.	Min.	Max.	Min.	Max.	Min.	Max.	Min.	Max.
MAXUM 7	7	19.66	24.16	20.66	25.16	21.41	25.91	22.41	26.91	23.41	27.91	24.41	28.91	25.41	29.91
MAXUM 9	9	21.78	26.28	22.78	27.28	23.53	28.03	24.53	29.03	25.53	30.03	26.53	31.03	27.53	32.03
MAXUM 10	10			23.84	28.34	24.59	29.09	25.59	30.09	26.59	31.09	27.59	32.09	28.59	33.09
MAXUM 11	11					27.73	31.87	28.37	32.87	29.37	33.87	30.37	34.87	31.37	35.87
MAXUM 12	12					28.37	32.87	29.37	33.87	30.37	34.87	31.37	35.87	32.37	36.87

■ Refer to Table 12, page G3-34 for compatibility of various combinations of reducers and accessories.

FEATURES/BENEFITS PAGE G3-3	NOMENCLATURE PAGE G3-6	EASY SELECTION PAGE G3-7	RELATED PRODUCTS PAGE G3-55
--------------------------------	---------------------------	-----------------------------	--------------------------------



## MAXUM Concentric Reducer

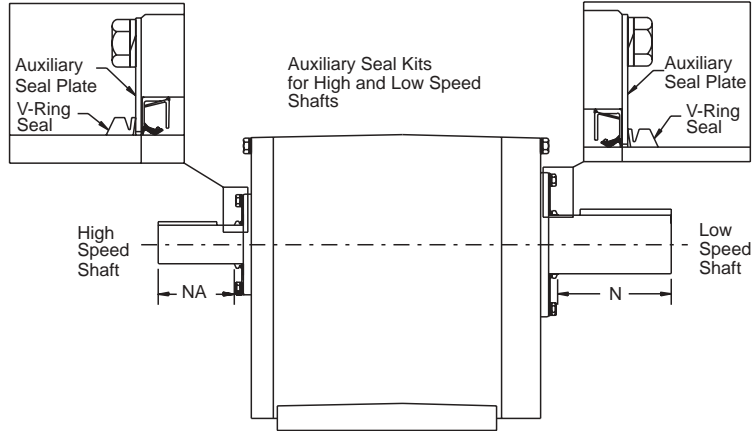

### AUXILIARY SEAL KITS

Where exposure to dust, moisture or other types of contamination is a potential problem, the optional MAXUM Reducer Auxiliary Seal Kit is recommended.

Kits consist of auxiliary seal plates and V-ring seals for both high speed and low speed shafts. The seal plate protects the seal from accidental damage and the V-ring provides extra sealing protection from external contaminants. Kits mount with no additional drilling and tapping.

### Filter Breathers\*

Reduced Size	Part Number	Housing Hole Dimensions
DCR/TCR 1-4	430048	3/8 - 18 NPSF
DCR/TCR 5-6	430049	1/2 - 14 NPSF
DCR/TCR 7-12	430049 ●	1-11 NPSF

\* Breathers fit all reducer ratios

- Order 1" x 1/2" adapter, part number A45631 for mounting Filter Breather to reducer housing.

Unit Size	Ratios	Part	NA	N
		Number		
DCR/TCR 1	2.25-194.6	299701	2.86	3.3
DCR/TCR 2	2.25-194.6	299699	2.86	4.05
DCR/TCR 3	2.25-194.6	300305	3.23	5.05
DCR/TCR 4	2.25-194.6	300302	3.23	5.45
DCR 5	2.25-25.63	300906	4.31	6.45
TCR 5	31.39-194.6	300903	3.23	6.45
DCR 6	2.25-25.63	300904	4.31	7.25
TCR 6	31.39-194.6	301204	3.23	7.25
DCR 7	5.06-25.63	301504	5.25	7.73
TCR 7	31.39-194.6	301504	3.77*	7.73
DCR 9	5.06-25.63	302104	6.00	10.46
TCR 9	31.39-194.6	302104	4.23*	10.46
DCR 10	5.06-25.63	302408	6.06	10.79
TCR 10	31.39-70.62	302408	5.90*	10.79
TCR 10	86.50-194.6	302408	4.78*	10.79
DCR 11	5.06-25.63	302711	5.33*	11.34
TCR 11	31.39-70.62	302711	5.37*	11.34
TCR 11	86.50-194.6	302711	4.18*	11.34
DCR 12	5.06-25.63	302713	5.33*	11.84
TCR 12	31.39-70.62	302713	5.37*	11.84
TCR 12	86.50-194.6	302713	4.18*	11.84

\* NA dimensions are the same with or without auxiliary seals.

■ Sizes 1-3 discontinued. Remaining stock may be available.

FEATURES/BENEFITS PAGE G3-3	NOMENCLATURE PAGE G3-6	EASY SELECTION PAGE G3-7	RELATED PRODUCTS PAGE G3-55
--------------------------------	---------------------------	-----------------------------	--------------------------------



## MAXUM Concentric Reducer

### MODIFICATIONS OR ASSEMBLY FOR MAXUM CONCENTRIC REDUCERS

#### CONSULT DODGE FOR THESE ASSEMBLIES, ACCESSORIES, AND MODIFICATIONS

- |     |  |
|-----|--|
| 1.  | MAXUM REDUCER MODIFIED FOR INCLINED OR VERTICAL SHAFT, EXCEEDING 10°. ADVISE IF INPUT SHAFT UP OR DOWN.  |
| 2.  | MAXUM REDUCER WITH AUXILIARY SEALS INSTALLED   |
| 3.  | MAXUM REDUCER WITH COOLING FAN INSTALLED   |
| 4.  | MAXUM REDUCER WITH EXTERNAL BACKSTOP ASSEMBLY INSTALLED. (SPECIFY DIRECTION OF ROTATION ON ORDER.)   |
| 5.  | MAXUM REDUCER AND ACCESSORIES PACKAGED FOR SHIPMENT ON ONE PALLET.   |
| 6.  | MAXUM SCOOP PACKAGE ASSEMBLED WITH RELIANCE MOTOR.   |
| 7.  | MAXUM HD (HEAVY DUTY) BASE PLATE PACKAGE ASSEMBLED WITH RELIANCE MOTOR.  |
| 8.  | MAXUM REDUCER WITH SPECIAL BEARING ADJUSTMENT  |
| 9.  | MAXUM REDUCER PREPARED FOR LONG-TERM STORAGE   |
| 10. | MAXUM REDUCER ASSEMBLED WITH FLUID COUPLING OR FLUID DRIVE.  |
| 11. | MAXUM REDUCER OPTIONS FOR HARSH ENVIRONMENTS<br>REDUCER PAINT OPTIONS<br>OPTIONAL BREATHERS<br>OIL SIGHT & WINDOW GAUGES<br>SPECIALTY LUBRICANTS<br>OIL SUMP HEATERS<br>STANDARD OIL SEAL REPLACEMENT KITS |