

RELATED PRODUCTS



TORQUE-ARM II Shaft Mount Speed Reducers HARSH DUTY ACCESSORIES

XT Safety & Sealing

Metal End Covers ⁽¹⁾ ⁽²⁾

Reducer Size	End Cover Part Numbers			
	Closed	Weight	Split	Weight
TA0107L	900114	0.3	900115	0.3
TA1107H	901114	0.5	901115	0.4
TA2115H	902114	0.6	902115	0.5
TA3203H	903114	1.0	903115	0.6
TA4207H	904114	1.2	904115	1.0
TA5215H	905114	1.3	905115	1.3
TA6307H	906114	1.0	906115	1.5
TA7315H	907114	1.2	907115	1.5
TA8407H	908114	2.5	908115	2.5
TA9415H	909114	4.0	909115	1.7
TA10507H	910114	4.6	910115	3.9
TA12608H	912114	4.8	912115	4.1

- (1) End covers fit both the input side and backstop side of TA II reducer. See Drawing A and Table 3 for dimensions.
- (2) If a TA II Belt Guard is used, an end cover for the input side of the reducer is not needed and will not fit.

Table 3

Reducer Size	A	B	C	D	E	F
TA0107L	7.77	3.63	3.63	2.14	0.22	0.05
TA1107H	7.95	4.13	4.13	2.02	-0.05	-0.22
TA2115H	8.80	4.75	4.75	2.19	0.07	-0.10
TA3203H	9.68	5.25	5.25	3.19	0.08	-0.10
TA4207H	9.95	5.88	5.88	3.21	0.14	-0.04
TA5215H	11.57	6.75	6.75	3.81	0.70	0.46
TA6307H	12.12	6.88	6.88	5.12	0.66	0.41
TA7315H	13.18	8.13	8.13	4.92	0.00	-0.41
TA8407H	14.12	8.38	8.38	5.45	0.19	-0.06
TA9415H	15.17	9.63	9.63	6.37	-0.79	-1.20
TA10507H	16.88	10.63	10.63	6.36	0.00	-0.34
TA12608H	19.75	11.88	11.88	6.47	-0.63	-1.09

Drawing A - Metal End Cover

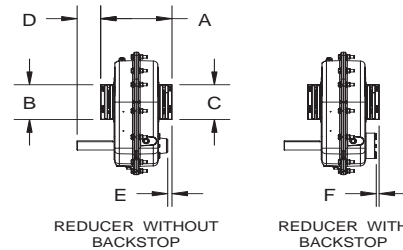

Enclosed Breather Chamber



Oil Sump Heater

Metal End Covers



XT Hostile Environment

Enclosed Breather Chamber

Reducer Size	Part Number
TA0-TA9	240050
TA10-TA12	240051

Filter Breather ⁽³⁾

Reducer Size	Part Number
TA0-TA3	430048
TA4-TA12	430049

Oil Sump Immersion Heaters ⁽³⁾ ⁽⁴⁾

Reducer Size	Part Number
TA0	Not Available
TA1-TA3	241103 ⁽⁴⁾
TA4-TA5	241104 ⁽⁴⁾
TA6-TA12	Consult DODGE ⁽⁴⁾

(3) 110 volt, single phase, AC cartridge heater, threads into special tapped housing hole. Provides for approximately 70 degrees (F) temperatures rise in one hour for cold climates. Simple time phased on/off construction without thermostat.

(4) All TA II reducers have to be factory modified to allow installation of sump heater. Consult DODGE.

(3) 40 micron mesh opening in filter allows reducer to breathe, yet keep dust out, under the most extreme conditions

FEATURES/BENEFITS PAGE G1-3	NOMENCLATURE PAGE G1-8	SELECTION PAGE G1-12	SELECTION/DIMENSION PAGE G1-36
--------------------------------	---------------------------	-------------------------	-----------------------------------



RELATED PRODUCTS

TORQUE-ARM II Shaft Mount Speed Reducers MAXIMUM BORE STRAIGHT BORE TA II REDUCERS

Maximum Bore Straight Bore TA II Reducers (1) (2) (3)

Reducer Size	Max. Bore	TA II Reducer									
		5:1		9:1		15:1		25:1		31:1 - 40:1	
		Part No.	Weight	Part No.	Weight	Part No.	Weight	Part No.	Weight	Part No.	Weight
TA1107H	1-11/16"	901149	56.6	901148	58.0	901147	57.9	901146	57.9	901145	58.0
TA3203H	2-7/16"	903149	109.2	903148	113.3	903147	113.1	903146	112.8	903145	112.0
TA4207H	2-15/16"	904149	182.0	904148	190.7	904147	190.3	904146	189.6	904145	189.0
TA5215H	3-7/16"	905149	262.4	905148	277.0	905147	276.5	905146	275.5	905145	274.7
TA6307H	3-15/16"	906149	316.0	906148	334.0	906147	333.0	906146	331.0	906145	330.0

- (1) See individual reducer catalog pages for accessories for above reducers
- (2) Non-stock, made-to-order reducers
- (3) See Drawing B and Table 4 for catalog dimensions for Maximum Bore Straight Bore TA II Reducers

Drawing B

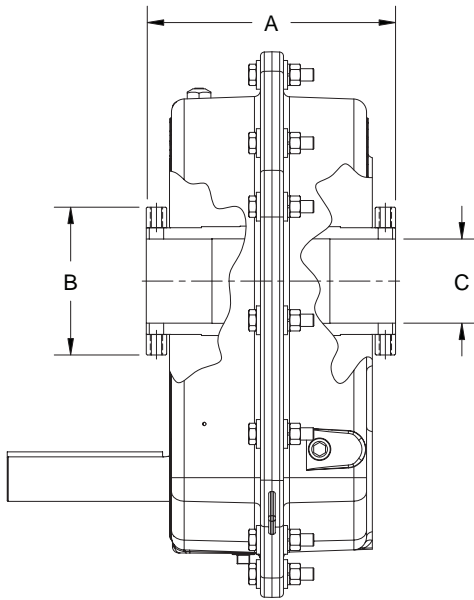

Table 4 (4)

Reducer Size	A	B	C Bore	Shaft Keyseat Required (5)
TA1107H	5.82	3.50	1-11/16"	3/8 x 3/16 x 5.81
TA3203H	7.59	4.50	2-7/16"	5/8 x 5/16 x 7.58
TA4207H	8.02	5.00	2-15/16"	3/4 x 3/8 x 8.01
TA5215H	8.97	5.50	3-7/16"	7/8 x 7/16 x 8.96
TA6307H	9.40	5.75	3-15/16"	1 x 1/2 x 9.39

- (4) Always check the driven shaft and key for strength
- (5) Minimum keyseat and shaft length required to mount reducer

FEATURES/BENEFITS PAGE G1-3	NOMENCLATURE PAGE G1-8	SELECTION PAGE G1-12	SELECTION/DIMENSION PAGE G1-36
--------------------------------	---------------------------	-------------------------	-----------------------------------



TORQUE-ARM II Shaft Mount Speed Reducers

NOMINAL SHEAVE RATIOS REQUIRED FOR DODGE TORQUE-ARM II REDUCERS - 5:1, 9:1, 15:1

Reducer Output RPM	5:1 Nominal Reducer Ratio			Reducer Output RPM	9:1 Nominal Reducer Ratio			Reducer Output RPM	15:1 Nominal Reducer Ratio		
	Motor Speed				Motor Speed				Motor Speed		
	1750	1450	1170		1750	1450	1170		1750	1450	1170
400	1.14	1.38	1.71	200	1.03	1.24	1.54	120	1.03	1.24	1.54
395	1.13	1.36	1.69	198	1.02	1.23	1.52	118	1.01	1.22	1.51
390	1.11	1.34	1.67	196	1.01	1.22	1.51	116	1.01	1.20	1.49
385	1.10	1.33	1.65	194	1.00	1.20	1.49	114	1.02	1.18	1.46
380	1.09	1.31	1.62	192	1.01	1.19	1.48	112	1.04	1.16	1.44
375	1.07	1.29	1.60	190	1.02	1.18	1.46	110	1.06	1.14	1.41
370	1.06	1.28	1.58	188	1.03	1.17	1.45	108	1.08	1.12	1.38
365	1.04	1.26	1.56	186	1.05	1.15	1.43	106	1.10	1.10	1.36
360	1.03	1.24	1.54	184	1.06	1.14	1.42	104	1.12	1.08	1.33
355	1.01	1.22	1.52	182	1.07	1.13	1.40	102	1.14	1.06	1.31
350	1.00	1.21	1.50	180	1.08	1.12	1.38	100	1.17	1.03	1.28
345	1.01	1.19	1.47	178	1.09	1.10	1.37	98	1.19	1.01	1.26
340	1.03	1.17	1.45	176	1.10	1.09	1.35	96	1.22	1.01	1.23
335	1.04	1.16	1.43	174	1.12	1.08	1.34	94	1.24	1.03	1.21
330	1.06	1.14	1.41	172	1.13	1.07	1.32	92	1.27	1.05	1.18
325	1.08	1.12	1.39	170	1.14	1.06	1.31	90	1.30	1.07	1.15
320	1.09	1.10	1.37	168	1.16	1.04	1.29	88	1.33	1.10	1.13
315	1.11	1.09	1.35	166	1.17	1.03	1.28	86	1.36	1.12	1.10
310	1.13	1.07	1.32	164	1.19	1.02	1.26	84	1.39	1.15	1.08
305	1.15	1.05	1.30	162	1.20	1.01	1.25	82	1.42	1.18	1.05
300	1.17	1.03	1.28	160	1.22	1.01	1.23	80	1.46	1.21	1.03
295	1.19	1.02	1.26	158	1.23	1.02	1.22	78	1.50	1.24	1.00
290	1.21	1.00	1.24	156	1.25	1.03	1.20	76	1.54	1.27	1.03
285	1.23	1.02	1.22	154	1.26	1.05	1.18	74	1.58	1.31	1.05
280	1.25	1.04	1.20	152	1.28	1.06	1.17	72	1.62	1.34	1.08
275	1.27	1.05	1.18	150	1.30	1.07	1.15	70	1.67	1.38	1.11
270	1.30	1.07	1.15	148	1.31	1.09	1.14	68	1.72	1.42	1.15
265	1.32	1.09	1.13	146	1.33	1.10	1.12	66	1.77	1.46	1.18
260	1.35	1.12	1.11	144	1.35	1.12	1.11	64	1.82	1.51	1.22
255	1.37	1.14	1.09	142	1.37	1.13	1.09	62	1.88	1.56	1.26
250	1.40	1.16	1.07	140	1.39	1.15	1.08	60	1.94	1.61	1.30
245	1.43	1.18	1.05	138	1.41	1.17	1.06	58	2.01	1.67	1.34
240	1.46	1.21	1.03	136	1.43	1.18	1.05	56	2.08	1.73	1.39
235	1.49	1.23	1.00	134	1.45	1.20	1.03	54	2.16	1.79	1.44
230	1.52	1.26	1.02	132	1.47	1.22	1.02	52	2.24	1.86	1.50
225	1.56	1.29	1.04	130	1.50	1.24	1.00	50	2.33	1.93	1.56
220	1.59	1.32	1.06	128	1.52	1.26	1.02	48	2.43	2.01	1.63
215	1.63	1.35	1.09	126	1.54	1.28	1.03	46	2.54	2.10	1.70
210	1.67	1.38	1.11	124	1.57	1.30	1.05	44	2.65	2.20	1.77
205	1.71	1.41	1.14	122	1.59	1.32	1.07	42	2.78	2.30	1.86
200	1.75	1.45	1.17	120	1.62	1.34	1.08	40	2.92	2.42	1.95
195	1.79	1.49	1.20	118	1.65	1.37	1.10	38	3.07	2.54	2.05
190	1.84	1.53	1.23	116	1.68	1.39	1.12	36	3.24	2.69	2.17
185	1.89	1.57	1.26	114	1.71	1.41	1.14	34	3.43	2.84	2.29
180	1.94	1.61	1.30	112	1.74	1.44	1.16	32	3.65	3.02	2.44
175	2.00	1.66	1.34	110	1.77	1.46	1.18	30	3.89	3.22	2.60
170	2.06	1.71	1.38	108	1.80	1.49	1.20	28	4.17	3.45	2.79
165	2.12	1.76	1.42	106	1.83	1.52	1.23	26	4.49	3.72	3.00
160	2.19	1.81	1.46	104	1.87	1.55	1.25	24	4.86	4.03	3.25
155	2.26	1.87	1.51	102	1.91	1.58	1.27	22	5.30	4.39	3.55
150	2.33	1.93	1.56	100	1.94	1.61	1.30	20	5.83	4.83	3.90
145	2.41	2.00	1.61					18	6.48	5.37	4.33
140	2.50	2.07	1.67					16	7.29	6.04	4.88
135	2.59	2.15	1.73					14	8.33	6.90	5.57
130	2.69	2.23	1.80					12	9.72	8.06	6.50
125	2.80	2.32	1.87					10	11.67	9.67	7.80
120	2.92	2.42	1.95								
115	3.04	2.52	2.03								
110	3.18	2.64	2.13								
105	3.33	2.76	2.23								
100	3.50	2.90	2.34								

Note: Speed increase ratios are shown in bold type

FEATURES/BENEFITS PAGE G1-3	NOMENCLATURE PAGE G1-8	SELECTION PAGE G1-12	SELECTION/DIMENSION PAGE G1-36
--------------------------------	---------------------------	-------------------------	-----------------------------------



RELATED PRODUCTS

TORQUE-ARM II Shaft Mount Speed Reducers

NOMINAL SHEAVE RATIOS REQUIRED FOR DODGE TORQUE-ARM II REDUCERS -
25:1, 31-32-33:1, 40:1

Reducer Output RPM	25:1 Nominal Reducer Ratio			Reducer Output RPM	31:1, 32:1 and 33:1 Nominal Reducer Ratios			Reducer Output RPM	40:1 Nominal Reducer Ratio		
	Motor Speed				Motor Speed				Motor Speed		
	1750	1450	1170		1750	1450	1170		1750	1450	1170
80	1.14	1.38	1.71	50	1.09	1.10	1.37	50	1.14	1.38	1.71
78	1.11	1.34	1.67	48	1.14	1.06	1.31	48	1.10	1.32	1.64
76	1.09	1.31	1.62	46	1.19	1.02	1.26	46	1.05	1.27	1.57
74	1.06	1.28	1.58	44	1.24	1.03	1.20	44	1.01	1.21	1.50
72	1.03	1.24	1.54	42	1.30	1.08	1.15	42	1.04	1.16	1.44
70	1.00	1.21	1.50	40	1.37	1.13	1.09	40	1.09	1.10	1.37
68	1.03	1.17	1.45	38	1.44	1.19	1.04	38	1.15	1.05	1.30
66	1.06	1.14	1.41	36	1.52	1.26	1.02	36	1.22	1.01	1.23
64	1.09	1.10	1.37	34	1.61	1.33	1.08	34	1.29	1.07	1.16
62	1.13	1.07	1.32	32	1.71	1.42	1.14	32	1.37	1.13	1.09
60	1.17	1.03	1.28	30	1.82	1.51	1.22	30	1.46	1.21	1.03
58	1.21	1.00	1.24	28	1.95	1.62	1.31	28	1.56	1.29	1.04
56	1.25	1.04	1.20	26	2.10	1.74	1.41	26	1.68	1.39	1.13
54	1.30	1.07	1.15	24	2.28	1.89	1.52	24	1.82	1.51	1.22
52	1.35	1.12	1.11	22	2.49	2.06	1.66	22	1.99	1.65	1.33
50	1.40	1.16	1.07	20	2.73	2.27	1.83	20	2.19	1.81	1.46
48	1.46	1.21	1.03	18	3.04	2.52	2.03	18	2.43	2.01	1.63
46	1.52	1.26	1.02	16	3.42	2.83	2.29	16	2.73	2.27	1.83
44	1.59	1.32	1.06	14	3.91	3.24	2.61	14	3.13	2.59	2.09
42	1.67	1.38	1.11	12	4.56	3.78	3.05	12	3.65	3.02	2.44
40	1.75	1.45	1.17	10	5.47	4.53	3.66	10	4.38	3.63	2.93
38	1.84	1.53	1.23	8	6.84	5.66	4.57	8	5.47	4.53	3.66
36	1.94	1.61	1.30	6	9.11	7.55	6.09	6	7.29	6.04	4.88
34	2.06	1.71	1.38								
32	2.19	1.81	1.46								
30	2.33	1.93	1.56								
28	2.50	2.07	1.67								
26	2.69	2.23	1.80								
24	2.92	2.42	1.95								
22	3.18	2.64	2.13								
20	3.50	2.90	2.34								
18	3.89	3.22	2.60								
16	4.38	3.63	2.93								
14	5.00	4.14	3.34								
12	5.83	4.83	3.90								
10	7.00	5.80	4.68								
8	8.75	7.25	5.85								
6	11.67	9.67	7.80								

RELATED PRODUCTS



TORQUE-ARM II Shaft Mount Speed Reducers

NOMINAL SHEAVE SPEED (RPM) AT INPUT FOR DODGE REDUCERS - 1750 MOTOR

Reducer Output RPM	5:1 Nominal Reducer Ratio	Reducer Output RPM	9:1 Nominal Reducer Ratio	Reducer Output RPM	15:1 Nominal Reducer Ratio	Reducer Output RPM	25:1 Nominal Reducer Ratio	Reducer Output RPM	31:1, 32:1 and 33:1 Nominal Reducer Ratios	Reducer Output RPM	40:1 Nominal Reducer Ratio
400	2000	200	1800	120	1800	80	2000	50	1600	50	2000
395	1975	198	1782	118	1770	78	1950	48	1536	48	1920
390	1950	196	1764	116	1740	76	1900	46	1472	46	1840
385	1925	194	1746	114	1710	74	1850	44	1408	44	1760
380	1900	192	1728	112	1680	72	1800	42	1344	42	1680
375	1875	190	1710	110	1650	70	1750	40	1280	40	1600
370	1850	188	1692	108	1620	68	1700	38	1216	38	1520
365	1825	186	1674	106	1590	66	1650	36	1152	36	1440
360	1800	184	1656	104	1560	64	1600	34	1088	34	1360
355	1775	182	1638	102	1530	62	1550	32	1024	32	1280
350	1750	180	1620	100	1500	60	1500	30	960	30	1200
345	1725	178	1602	98	1470	58	1450	28	896	28	1120
340	1700	176	1584	96	1440	56	1400	26	832	26	1040
335	1675	174	1566	94	1410	54	1350	24	768	24	960
330	1650	172	1548	92	1380	52	1300	22	704	22	880
325	1625	170	1530	90	1350	50	1250	20	640	20	800
320	1600	168	1512	88	1320	48	1200	18	576	18	720
315	1575	166	1494	86	1290	46	1150	16	512	16	640
310	1550	164	1476	84	1260	44	1100	14	448	14	560
305	1525	162	1458	82	1230	42	1050	12	384	12	480
300	1500	160	1440	80	1200	40	1000	10	320	10	400
295	1475	158	1422	78	1170	38	950	8	256	8	320
290	1450	156	1404	76	1140	36	900	6	192	6	240
285	1425	154	1386	74	1110	34	850				
280	1400	152	1368	72	1080	32	800				
275	1375	150	1350	70	1050	30	750				
270	1350	148	1332	68	1020	28	700				
265	1325	146	1314	66	990	26	650				
260	1300	144	1296	64	960	24	600				
255	1275	142	1278	62	930	22	550				
250	1250	140	1260	60	900	20	500				
245	1225	138	1242	58	870	18	450				
240	1200	136	1224	56	840	16	400				
235	1175	134	1206	54	810	14	350				
230	1150	132	1188	52	780	12	300				
225	1125	130	1170	50	750	10	250				
220	1100	128	1152	48	720	8	200				
215	1075	126	1134	46	690	6	150				
210	1050	124	1116	44	660						
205	1025	122	1098	42	630						
200	1000	120	1080	40	600						
195	975	118	1062	38	570						
190	950	116	1044	36	540						
185	925	114	1026	34	510						
180	900	112	1008	32	480						
175	875	110	990	30	450						
170	850	108	972	28	420						
165	825	106	954	26	390						
160	800	104	936	24	360						
155	775	102	918	22	330						
150	750	100	900	20	300						
145	725			18	270						
140	700			16	240						
135	675			14	210						
130	650			12	180						
125	625			10	150						
120	600										
115	575										
110	550										
105	525										
100	500										

Gearing Reference Guide

TORQUE-ARM II

TORQUE-ARM

MAXIMUM Concentric Reducer

TIGEAR-2

FEATURES/BENEFITS PAGE G1-3	NOMENCLATURE PAGE G1-8	SELECTION PAGE G1-12	SELECTION/DIMENSION PAGE G1-36
--------------------------------	---------------------------	-------------------------	-----------------------------------

RENEWAL PARTS



TORQUE-ARM II Shaft Mount Speed Reducers RENEWAL PARTS FOR TA II REDUCERS

Torque-Arm II Bearing Kits ⁽¹⁾

Size	Ratio	Kit P/N	Size	Ratio	Kit P/N
TA0107L	5:1	900128	TA6307H	5:1	906128
TA0107L	9:1 - 40:1	900129	TA6307H	9:1 - 15:1	906129
TA1107H	5:1	901128	TA6307H	25:1 - 40:1	906130
TA1107H	9:1 - 15:1	901129	TA7315H	5:1	907128
TA1107H	25:1 - 40:1	901130	TA7315H	9:1 - 25:1	907129
TA2115H	5:1	902128	TA7315H	40:1	907130
TA2115H	9:1 - 25:1	902129	TA8407H	15:1 - 25:1	908129
TA2115H	40:1	902130	TA8407H	40:1	908130
TA3203H	5:1	903128	TA9415H	15:1 - 25:1	909129
TA3203H	9:1 - 25:1	903129	TA9415H	40:1	909130
TA3203H	40:1	903130	TA10507H	15:1 - 25:1	910129
TA4207H	5:1	904128	TA10507H	40:1	910130
TA4207H	9:1 - 25:1	904129	TA12608H	15:1 - 25:1	912129
TA4207H	40:1	904130	TA12608H	40:1	912130
TA5215H	5:1	905128			
TA5215H	9:1 - 15:1	905129			
TA5215H	25:1	905130			
TA5215H	40:1	905131			

(1) Kit contains complete set of bearings for reducer size and ratio indicated.

Torque-Arm II Level I Rebuild Kits ⁽³⁾

Size	Ratio	Kit P/N	Size	Ratio	Kit P/N
TA0107L	5:1	900135	TA6307H	5:1	906135
TA0107L	9:1 - 40:1	900136	TA6307H	9:1 - 15:1	906136
TA1107H	5:1	901135	TA6307H	25:1 - 40:1	906137
TA1107H	9:1 - 15:1	901136	TA7315H	5:1	907135
TA1107H	25:1 - 40:1	901137	TA7315H	9:1 - 25:1	907136
TA2115H	5:1	902135	TA7315H	40:1	907137
TA2115H	9:1 - 25:1	902136	TA8407H	15:1 - 25:1	908136
TA2115H	40:1	902137	TA8407H	40:1	908137
TA3203H	5:1	903135	TA9415H	15:1 - 25:1	909136
TA3203H	9:1 - 25:1	903136	TA9415H	40:1	909137
TA3203H	40:1	903137	TA10507H	15:1 - 25:1	910136
TA4207H	5:1	904135	TA10507H	40:1	910137
TA4207H	9:1 - 25:1	904136	TA12608H	15:1 - 25:1	912136
TA4207H	40:1	904137	TA12608H	40:1	912137
TA5215H	5:1	905135			
TA5215H	9:1 - 15:1	905136			
TA5215H	25:1	905137			
TA5215H	40:1	905138			

(3) Level 1 Rebuild Kit includes input & output seals, all bearings, shims and sealant for reducer size and ratio indicated. Level II protection can be provided by stocking an input shaft with pinion and a first reduction gear, along with a Level I Rebuild Kit from the above list. See Instruction Manual # 499385 for gearing part numbers.

Torque-Arm II Seal Kits ⁽²⁾

Size	Ratio	Kit P/N
TA0107L	All	900126
TA1107H	All	901126
TA2115H	5:1 - 25:1	902126
TA2115H	40:1	902127
TA3203H	5:1-25:1	903126
TA3203H	40:1	903127
TA4207H	All	904126
TA5215H	All	905126
TA6307H	All	906126
TA7315H	All	907126
TA8407H	All	908126
TA9415H	All	909126
TA10507	All	910126
TA12608	All	912126

(2) Kit includes input & output seals, backstop cover gasket and RTV sealant for reducer size and ratio indicated

Torque-Arm II Shim Kits ⁽⁴⁾

Size	Shim Output Brg	Shim Input Brg	Shim Coshaft Brg
TA0107L	900132	901134	900134
TA1107H	901132	901133	901134
TA2115H	902132	902133	901133
TA3203H	903132	903134	903134
TA4207H	904132	903134	903134
TA5215H	905132	905133	905133
TA6307H	906132	906133	906133
TA7315H	907132	907133	906133
TA8407H	907132	903132	908134
TA9415H	909132	909134	909134
TA10507H	910132	910133	904132
TA12608H	912132	910133	912134

(4) Kit contains complete set of shims for reducer size and location indicated.