



TORQUE-ARM Shaft Mount Speed Reducers

TABLE 5- DODGE TORQUE-ARM REDUCERS AND ACCESSORIES COMPATIBILITY

TXT Reducer	Maximum Bore	AGMA Code	Input HP @75 RPM Output 15, 25:1	Input HP @100 RPM Output 5:1	Taper Bushed	Straight Bore	HYDROIL Style	Vertical Style	Motor Mount	Backstop	Taconite Auxiliary Seals	Belt Guards
TXT1	1-7/16"	107	4.15	4.49	Yes	Yes	Yes	Yes	Yes	Yes	Yes	Yes
TXT2	1-15/16"	115	7.52	7.70	Yes	Yes	Yes	Yes	Yes	Yes	Yes	Yes
TXT3	2-3/16"	203	12.7	11.7	Yes	Yes	Yes	Yes	Yes	Yes	Yes	Yes
TXT4	2-7/16"	207	19.3	19.6	Yes	Yes	Yes	Yes	Yes	Yes	Yes	Yes
TXT5	2-15/16"	215	29.9	25.0	Yes	Yes	Yes	Yes	Yes	Yes	Yes	Yes
TXT6	3-7/16"	307	50.3	51.6	Yes	Yes	Yes	Yes	Yes	Yes	Yes	Yes
TXT7	3-15/16"	315	72.3	87.4	Yes	Yes	Yes	Yes	Yes	Yes	Yes	Yes
TXT8	4-7/16"	407	106.9	111.0	Yes	Yes	-	Yes	Yes	Yes	Yes	Yes
TXT9	4-15/16"	415	154.7	140.0	Yes	Yes	-	Yes	Yes	Yes	Yes	Yes
TXT10	5-7/16"	507	216.0	-	Yes	Yes	-	Yes	Yes	Yes	Yes	Yes
TXT12	6-1/2"	608	275.0	-	Yes	-	-	Yes	Yes	Yes	Yes	Yes
TDT13	7"	700	374.0	-	Yes	-	-	Yes	Yes	Yes	Yes	Yes
TDT14	8"	800	561.0	-	Yes	-	-	Yes	Yes	Yes	Yes	Yes
TDT15	10"	1000	-	-	Yes	-	-	Yes	Yes	Yes	Yes	Yes

TABLE 6 - DODGE SCREW CONVEYOR DRIVE REDUCERS AND ACCESSORIES COMPATIBILITY

SCXT Reducer	AGMA Code	Input HP@ 75 RPM Output 15,25:1	Input HP@100 RPM Output 5:1	HYDROIL Style	Drive Shafts	Adapter	Motor Mount	Taconite Auxiliary Seals	Belt Guards
SCXT1	107	4.15	4.49	Yes	Yes	Yes	Yes	Yes	Yes
SCXT2	115	7.52	7.70	Yes	Yes	Yes	Yes	Yes	Yes
SCXT3	203	12.70	11.70	Yes	Yes	Yes	Yes	Yes	Yes
SCXT4	207	19.30	19.60	Yes	Yes	Yes	Yes	Yes	Yes
SCXT5	215	29.90	25.00	Yes	Yes	Yes	Yes	Yes	Yes
SCXT6	307	50.30	51.60	Yes	Yes	Yes	Yes	Yes	Yes
SCXT7	315	72.30	87.40	Yes	Yes	Yes	Yes	Yes	Yes
SCXT8	407	106.90	111.00	-	Yes	Yes	Yes	Yes	Yes



TORQUE-ARM Shaft Mount Speed Reducers

**TABLE 7 - NEMA MOTOR INFORMATION
(1750 RPM)**

Horsepower	NEMA Motor Frame	Shaft Diameter	Minimum Sheave Diameters
1	143T	7/8	2.2
1-1/2	145T	7/8	2.4
2	145T	7/8	2.4
3	182T	1-1/8	2.4
5	184T	1-1/8	3.0
7-1/2	213T	1-3/8	3.0
10	215T	1-3/8	3.8
15	254T	1-5/8	4.4
20	256T	1-5/8	4.4
25	284T	1-7/8	4.4
30	286T	1-7/8	5.2
40	324T	2-1/8	6.0
50	326T	2-1/8	6.8
60	364T	2-3/8	7.4
75	365T	2-3/8	8.6
100	+405T	2-7/8	8.6
125	+444T	3-3/8	10.5
150	+445T	3-3/8	10.5
200	+447T	3-3/8	13.2

+ Energy Efficient (TEFC-XE) Frame

**TABLE 8 - MINIMUM SHEAVE DIAMETERS FOR DODGE
TORQUE-ARM REDUCERS**

TXT, SCXT Reducer	Single Reduction		Double Reduction			
	Shaft Diameter	5:1	Shaft Diameter	9:1	15:1	25:1
1	1-1/8	4.0	3/4	4.0	3.0	3.0
2	1-7/16	3.0	1-1/8	5.0	3.0	3.0
3	1-5/8	7.0	1-1/4	5.0	4.0	4.0
4	1-15/16	7.5	1-7/16	6.5	4.6	4.6
5	2-3/16	9.5	1-15/16	7.0	5.4	5.4
6	2-3/16	6.5	2-3/16	7.0	6.2	6.2
7	2-7/16	7.5	2-7/16	7.0	6.2	6.2
8	2-7/16	9.2	2-7/16		6.2	6.2
9	2-7/16	9.5	2-7/16		8.0	8.0
10			2-11/16		8.5	8.5
12			2-11/16		9.5	9.5
13			2-15/16			12.0
14			2-15/16			15.0
15			3-7/16			20.0

MODIFICATIONS/ ACCESSORIES



TORQUE-ARM Shaft Mount Speed Reducers

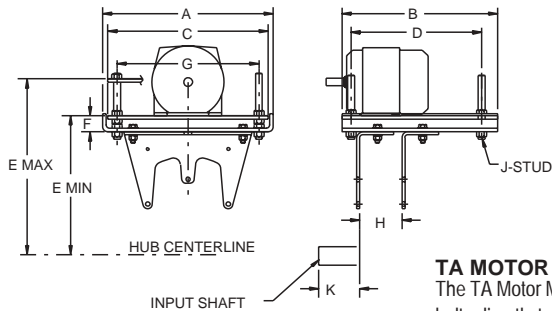

TA MOTOR MOUNTS

The TA Motor Mount is a rugged all steel unit which requires no drilling and no foundation. It bolts directly to the top of the TORQUE-ARM reducer and can be located in any position around the shaft. It permits easy belt tensing.

Each motor mount accommodates a wide variety of NEMA motor frames - see table below.

All motor mount fasteners are supplied with zinc-plated finish as standard Bolt hole configuration will also allow this mount to fasten to the top of a Screw Conveyor Drive reducer of equivalent size.

TORQUE-ARM MOTOR MOUNTS - TA1M THRU TA7M

MOTOR MOUNT NO. ■	PART NUMBER ●	WT.	REDUCER SIZE	NEMA MOTOR FRAME	A	B	C	D	E ◆		F	G	H	J	K
									MIN	MAX					
TA1M	241391	37	TXT1	56T - 215T	14.63	11.00	13.50	9.25	10.03	14.18	1.59	12.00	3.38	5/8 x 7	3.88
			TXT2						10.59	14.75					4.18
TA3M	243391	40	TXT3A	56T - 215T	14.63	11.00	13.50	9.25	11.59	15.78	1.62	12.00	4.25	5/8 x 7	4.88
	243393 ▲	70		254T - 256T	18.63	17.00	17.50	14.25	11.59	15.78	1.59	15.50		3/4 x 8	
TA4M	244391	75	TXT4A	143T - 286T	18.63	17.00	17.50	14.25	11.96	16.73	1.78	15.50	4.63	3/4 x 8	6.13
TA5M	245391	76	TXT5B	143T - 286T	18.63	17.00	17.50	14.25	12.53	17.28	1.84	15.50	4.13	3/4 x 8	6.65
	245393 ▲			324T - 326T	20.50	18.50	19.25	16.50	12.53	17.28	1.84	17.50		3/4 x 8	
TA6M	246391	99	TXT6	143T - 326T	20.50	18.50	19.25	16.50	14.56	19.31	1.84	17.50	4.50	3/4 x 8	7.31
TA7M	247395	110	TXT7	143T - 365T	22.50	19.00	21.25	16.50	17.62	22.13	2.50	19.25	4.75	1 x 9	7.81

V-BELT DRIVE CENTER DISTANCES FOR TA1M THRU TA7M TORQUE-ARM MOTOR MOUNTS

MOTOR MOUNT NO.	REDUCER SIZE	CENTER DISTANCES FOR VARIOUS NEMA MOTOR FRAMES															
		56		140		180		210		250		280		320		360	
		MIN	MAX	MIN	MAX	MIN	MAX	MIN	MAX	MIN	MAX	MIN	MAX	MIN	MAX	MIN	MAX
TA1M	TXT1	17.6	21.0	17.6	21.0	18.5	22.0	19.3	22.7								
	TXT2	18.7	22.1	18.7	22.1	19.7	23.1	20.5	23.9								
TA3M	TXT3A	20.2	23.6	20.2	23.6	21.2	24.6	22.0	25.3	23.0	26.3						
TA4M	TXT4A			21.2	25.2	22.2	26.2	23.0	26.9	23.9	27.9	24.7	28.7				
TA5M	TXT5B			22.7	26.6	23.7	27.6	24.4	28.4	25.4	29.4	26.2	30.1	27.2	31.1		
TA6M	TXT6			25.9	29.7	26.9	30.7	27.6	31.4	28.6	32.4	29.4	33.2	30.4	34.2		
TA7M	TXT7			30.6	34.4	31.6	35.4	32.4	36.2	33.4	37.2	34.1	37.9	35.1	38.9	36.1	40.0

- Can be used with any ratio TORQUE-ARM Reducer (5, 9, 15, 25)
- Necessary mounting bolts are included
- ▲ Made to order belt buards required for these motor mounts. Consult DODGE.
- ◆ Provides for V-belt adjustment

FEATURES/BENEFITS PAGE G2-3	NOMENCLATURE PAGE G2-11	SELECTION/DIMENSIONS PAGE G2-28	RELATED PRODUCTS PAGE G2-152
--------------------------------	----------------------------	------------------------------------	---------------------------------



TORQUE-ARM Shaft Mount Speed Reducers

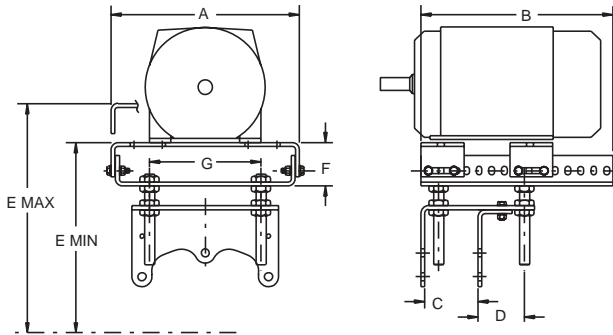

TORQUE-ARM MOTOR MOUNTS - TA8 THRU TA15

MOTOR MOUNT NO.	PART NUMBER	WT.	REDUCER SIZE	NOMINAL RATIO	NEMA MOTOR FRAME	A	B	C	D	E ♦		F	G
										MIN	MAX		
TA8	248401	119	TXT8	15, 25	213T - 365T	18.63	19.00	5.25	4.36	19.40	23.90	4.25	11.00
				5	254T - 365T								
TA9	249401	120	TXT9	15, 26	213T - 365T	18.63	19.00	5.25	4.63	21.46	25.90	4.25	11.00
	249399 ♣ ▲	125		5	284T - 365T								
TA10	250401	130	TXT10	15, 24	254T - 365T	18.63	19.00	6.00	3.88	22.60	27.09	4.25	11.00
	250404	200			404T - 445T								
TA12	272310	255	TXT12	15, 25	286T - 445T	25.06	24.00	7.63	5.25	25.65	31.13	3.81	18.50
TA13	272313	290	TDT13	25	324T - 445T	25.06	24.00	8.75	8.63	25.65	31.13	3.81	18.50
TA14	272318	295	TDT14	25	324T - 447T	25.06	24.00	10.00	7.38	25.81	31.31	3.81	18.50
TA15	272392	320	TDT15	30	405T - 449T	25.06	24.00	12.63	5.75	33.50	39.00	3.81	18.50

V-BELT DRIVE CENTER DISTANCES FOR TA8 THRU TA15 TORQUE-ARM MOTOR MOUNTS

MOTOR MOUNT NO.	REDUCER SIZE	NOMINAL RATIO	CENTER DISTANCES FOR VARIOUS NEMA MOTOR FRAMES													
			210		250		280		320		360		400		440	
			MIN	MAX	MIN	MAX	MIN	MAX	MIN	MAX	MIN	MAX	MIN	MAX	MIN	MAX
TA8	TXT8	15, 25	35.5	40.5	36.4	41.2	37.2	42.2	38.2	43.2	39.2	44.2				
		5			37.2	41.5	37.9	42.3	38.9	43.3	39.9	44.3				
TA9	TXT9	15, 26	38.0	43.0	39.0	44.0	39.8	44.7	40.7	45.7	41.7	46.7	42.8	47.7		
		5					40.5	44.8	41.5	45.8	42.5	46.8	43.5	47.8		
TA10	TXT10	15, 24			42.6	47.5	43.3	48.2	44.3	49.2	45.3	50.2	45.8	50.7	47.3	51.7
TA12	TXT12	15, 25					57.0	61.0	57.7	62.1	58.7	63.1	59.7	64.1	60.7	65.1
TA13	TDT13	25							59.7	65.1	60.7	66.1	61.7	67.1	62.0	66.7
TA14	TDT14	25							61.7	67.1	62.7	68.1	63.7	69.1	64.7	70.1
TA15	TDT15	30											75.0	80.5	76.0	81.5

- Necessary mounting bolts are included
- ▲ Made to order belt guards required for these motor mounts. Consult DODGE.
- ♦ Provides for V-belt adjustment
- ♣ Made to order.

FEATURES/BENEFITS PAGE G2-3	NOMENCLATURE PAGE G2-11	SELECTION/DIMENSIONS PAGE G2-28	RELATED PRODUCTS PAGE G2-152
--------------------------------	----------------------------	------------------------------------	---------------------------------

MODIFICATIONS/ ACCESSORIES

DODGE®

TORQUE-ARM Shaft Mount Speed Reducers

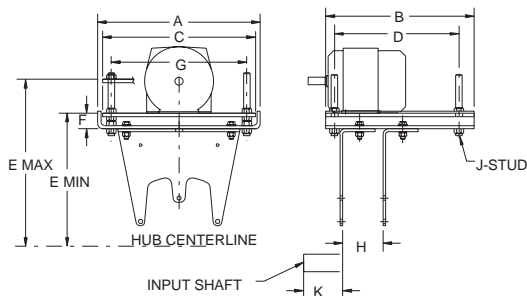

TAML LONG MOTOR MOUNTS

The TAML Motor Mount has longer support brackets, which allows for more clearance between the conveyor pulley and the bottom plate of the motor mount. (Reference table below for clearance dimensions). The motor mount is a rugged all steel unit which requires no drilling and no foundation. It bolts directly to the top of the TORQUE-ARM reducer and can be located in any position around the shaft. It permits easy belt tensioning and accommodates a wide variety of NEMA motor frames.

All motor mount fasteners are supplied with zinc-plated finish as standard.

Bolt hole configuration will also allow this mount to fasten to the top of a Screw Conveyor Drive Reducer of equivalent size.

TORQUE-ARM LONG MOTOR MOUNTS - TA3ML THRU TA7ML ▲ †

MOTOR MOUNT NO. ■	PART NUMBER ●	WT.	REDUCER SIZE	NEMA MOTOR FRAME	A	B	C	D	E ◆		F	G	H	J	K
									MIN	MAX					
TA3ML	243392	42	TXT3A	56T - 215T	14.63	11.00	13.50	9.25	14.59	18.72	1.59	12.00	4.25	5/8 x 7	4.88
TA4ML	244392	78	TXT4A	143T - 286T	18.63	17.00	17.50	14.25	16.46	21.20	1.78	15.50	4.63	3/4 x 8	6.13
TA5ML	245392	80	TXT5B	143T - 286T	18.63	17.00	17.50	14.25	19.28	24.03	1.84	15.50	4.13	3/4 x 8	6.65
TA6ML	246390	102	TXT6	143T - 326T	20.50	18.50	19.25	16.50	28.56	33.30	1.84	17.50	4.50	3/4 x 8	7.31
TA7ML	247396	115	TXT7	143T - 326T	22.50	19.00	21.25	16.50	32.46	37.20	1.84	19.25	4.75	3/4 x 8	7.81

V-BELT DRIVE CENTER DISTANCES FOR TA3ML THRU TA7ML TORQUE-ARM LONG MOTOR MOUNTS

MOTOR MOUNT NO.	REDUCER SIZE	CENTER DISTANCES FOR VARIOUS NEMA MOTOR FRAMES													
		56		140		180		210		250		280		320	
		MIN	MAX	MIN	MAX	MIN	MAX	MIN	MAX	MIN	MAX	MIN	MAX	MIN	MAX
TA3ML	TXT3A	23.1	26.5	23.1	26.5	24.1	27.5	24.9	28.3						
TA4ML	TXT4A			25.6	30.6	26.7	30.6	27.4	31.4	28.3	32.4	29.2	33.1		
TA5ML	TXT5B			29.4	33.4	30.4	34.3	31.1	35.1	32.1	36.1	32.9	36.8		
TA6ML	TXT6					40.8	44.6	41.6	45.4	42.6	46.4	43.3	47.1	44.3	48.1
TA7ML	TXT7					47.0	50.8	47.7	51.5	48.7	52.5	49.5	53.3	50.5	54.3

CLEARANCE DIMENSIONS ■

REDUCER	MOTOR MOUNT	CLEARANCE DIMENSIONS (1)
TXT1	TA1M	7.63
TXT2	TA1M	8.25
TXT3A	TA3M	9.25
TXT4A	TA4M	9.44
TXT5B	TA5M	10.00
TXT6	TA6M	11.97
TXT7	TA7M	14.38

CLEARANCE DIMENSIONS ■

REDUCER	MOTOR MOUNT	CLEARANCE DIMENSIONS (1)
TXT3A	TA3ML	12.25
TXT4A	TA4ML	13.94
TXT5B	TA5ML	16.75
TXT6	TA6ML	25.96
TXT7	TA7ML	29.88

(1) Distance from centerline of head shaft (reducer bore) and lowest component of motor mount hardware extending over top of convey

- Can be used with any ratio TORQUE-ARM Reducer (5, 9, 15, 25)
- Necessary mounting bolts are included
- ▲ Made to order belt guards required for these motor mounts. Consult DODGE.
- ◆ Provides for V-belt adjustment
- † Consult DODGE for Long Motor Mounts for reducers TXT8 and larger.

FEATURES/BENEFITS PAGE G2-3	NOMENCLATURE PAGE G2-11	SELECTION/DIMENSIONS PAGE G2-28	RELATED PRODUCTS PAGE G2-152
--------------------------------	----------------------------	------------------------------------	---------------------------------



TORQUE-ARM Shaft Mount Speed Reducers

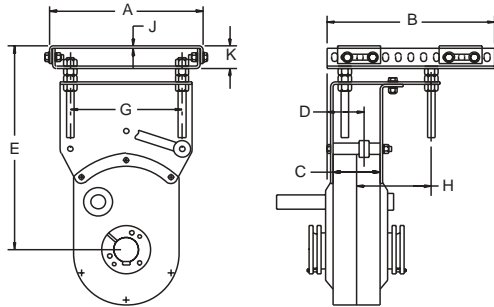

TAB BOTTOM MOTOR MOUNTS

For those applications where space constraints do not allow a DODGE TORQUE-ARM motor mount to be mounted from the top end of the reducer with our standard TORQUE-ARM motor mounts, TAB Bottom Motor Mounts are available. The TAB Motor Mount is a rugged all-steel unit which requires no drilling or foundation. It bolts directly to the bottom of a TORQUE-ARM reducer housing and also serves as a support member for the TORQUE-ARM rod assembly. Each mount accommodates a wide variety of NEMA AC motor frames. For initial belt installation, the adjusting screws can be set at a minimum position which offers adequate future V-belt adjustment.

TORQUE-ARM BOTTOM MOTOR MOUNTS - TAB 1 THRU TAB 10 ▲

MOTOR MOUNT NO.	PART NUMBER	WT.	REDUCER SIZE	NOMINAL RATIO	NEMA MOTOR FRAME	A	B	C	D	E ◆		G	H	J	K
										MIN	MAX				
TAB1	241421	40	TXT1	5, 9, 15, 25	56T - 215T	12-1/8	11-1/2	3-3/8	2-43/64	14-17/64	17-61/64	8	5-25/32	1/4	2-3/8
TAB2	242421	45	TXT2	5, 9, 15, 25	56T - 215T	12-1/8	11-1/2	3-3/8	2-43/64	14-29/32	18-19/32	8	5-25/32	1/4	2-3/8
TAB3	243404	60	TXT3A	5, 9, 15, 25	143T - 286T	15-1/8	16-1/2	4-1/4	3-15/32	19-1/4	23-7/8	11	5-13/32	1/4	2-3/8
TAB4	244404	65	TXT4A	5, 9, 15, 25	143T - 145T 182T - 326T	15-1/8	16-1/2	4-5/8	5-13/32 3-21/32	20-13/32	25-1/32	11	5-1/32	1/4	2-3/8
TAB5	245405	70	TXT5B	5, 9, 15, 25	143T - 145T 182T - 326T	15-1/8	16-1/2	4-1/8	5-21/64 3-37/64	21-15/32	26-3/32	11	5-17/32	1/4	2-3/8
TAB6	246392	75	TXT6	5, 9, 15, 25	182T - 215T 254T - 326T	15-1/8	16-1/2	4-1/2	5-5/32 3-13/32	24-1/4	28-13/16	11	5-17/16	1/4	2-3/8
TAB7	247404	85	TXT7	5, 9, 15, 25	182T - 215T 254T - 326T	15-1/8	16-1/2	4-3/4	5-1/2 3-3/4	27-3/4	32-1/4	11	5-1/8	1/4	2-3/8
TAB8	248406	90	TXT8	5, 15, 25	213T - 256T 284T - 365T	15-1/8	19	5-1/4	3-5/8 3-7/8	33-13/32	37-25/32	11	4-5/8	3/8	4-1/4
TAB9	249404	95	TXT9	5, 15, 26	213T - 256T 284T - 365T	18-5/8	19	5-1/4	5-5/8 3-7/8	34-29/32	39-9/32	11	4-5/8	3/8	4-1/4
TAB10	250411	105	TXT10	15, 24	254T - 365T	25-1/16	24	6	4-23/32	36-3/32	41-17/32	18-1/2	4-1/8	3/8	3-13/16

● Necessary mounting bolts are included.

◆ Provides for V-belt adjustment.

▲ Made to order belt guards required for these motor mounts. Consult DODGE

V-BELT DRIVE CENTER DISTANCES FOR TORQUE-ARM BOTTOM MOTOR MOUNTS

MOTOR MOUNT NO.	REDUCER SIZE	NOMINAL RATIO	CENTER DISTANCES FOR VARIOUS NEMA MOTOR FRAMES															
			56		140		180		210		250		280		320		360	
			MIN	MAX	MIN	MAX	MIN	MAX	MIN	MAX	MIN	MAX	MIN	MAX	MIN	MAX	MIN	MAX
TAB1	TXT1	9, 15, 25	14.70	18.40	14.70	18.40	15.70	19.40										
		5	14.50	18.20	14.50	18.20	16.30	19.20	17.20	19.90								
TAB2	TXT2	9, 15, 25	14.80	18.50	14.80	18.50	15.80	19.50	16.50	20.20								
		5			14.60	18.20	15.60	19.20	16.30	20.00								
TAB3	TXT3A	9, 15, 25	18.70	23.30	18.70	23.30	19.70	24.30	20.50	25.10								
		5			19.50	24.10	20.20	24.80	21.20	25.80								
TAB4	TXT4A	9, 15, 25	19.30	23.90	19.30	23.90	20.30	24.90	21.10	25.70	22.10	26.60						
		5			20.00	24.70	20.80	25.40	21.80	26.40	22.50	27.20						
TAB5	TXT5B	9, 15, 25			19.50	24.10	20.50	25.10	21.30	25.90	22.30	26.90	23.00	27.60				
	TXT5A	5					20.90	25.50	21.90	26.50	22.60	27.20	23.60	28.20				
TAB6	TXT6	9, 15, 25			21.40	25.90	22.40	26.90	23.10	27.60	24.10	28.60	24.90	29.40	25.80	30.40		
		5							23.60	28.20	24.40	28.90	25.40	29.90				
TAB7	TXT7	9, 15, 25					24.50	28.90	25.20	29.70	26.20	30.60	26.90	31.40	27.90	32.40		
		5							25.70	30.20	26.40	30.90	27.40	31.90				
TAB8	TXT8	15, 25							29.50	33.80	30.50	34.80	31.20	35.60	32.20	36.50	33.20	37.50
		5									30.50	34.90	31.50	35.90	32.50	36.90		
TAB9	TXT9	15, 26							29.90	34.10	30.80	35.10	31.60	35.90	32.50	36.80	33.50	37.80
		5											31.70	36.10	32.70	37.10		
TAB10	TXT10	15, 24									32.00	37.00	32.80	38.00	33.70	39.00	34.70	40.00

FEATURES/BENEFITS PAGE G2-3	NOMENCLATURE PAGE G2-11	SELECTION/DIMENSIONS PAGE G2-28	RELATED PRODUCTS PAGE G2-152
--------------------------------	----------------------------	------------------------------------	---------------------------------

MODIFICATIONS/ ACCESSORIES



TORQUE-ARM Shaft Mount Speed Reducers



SLOTTED METAL PANEL BELT GUARD

Belt guards with mounting straps for TXT Reducers will fit standard TA motor mounts. The belt guards are designed to fit most common sheave diameters. They mount easily with no machining required.

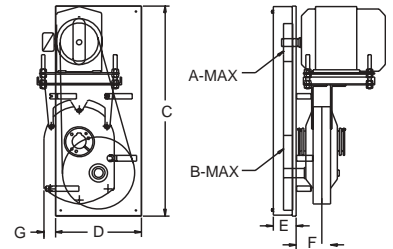

BELT GUARDS FOR DOUBLE REDUCTION TXT REDUCERS (9, 15, 25:1) WITH STANDARD MOTOR MOUNTS ■

REDUCE RSIZE	BELT GUARD SIZE	PART NUMBER	MOTOR MOUNT NO.	WT.	NEMA MOTOR FRAME	CENTER DISTANCE		A	B	C	D	E	F	G
						MIN	MAX							
TXT1	TXT1D	241395	TA1M	30	56T-215T	17.6	22.7	5.0	12.0	32.0	13.0	3.50	3.63	-
TXT2	TXT2D	242395	TA1M	36	56T-215T	18.7	23.9	6.0	12.0	34.0	15.0	4.00	3.50	-
TXT3A	TXT3D	243387 ▲	TA3M	43	56T-215T	20.2	25.3	7.0	14.0	37.0	17.0	4.00	3.94	-
TXT4A	TXT4D	244395	TA4M	54	143T-286T	21.2	28.7	7.0	15.0	43.0	18.0	4.50	5.19	-
TXT5B	TXT5D	245387 ▲	TA5M	75	143T-286T	22.7	30.2	7.0	15.0	45.0	18.0	4.25	5.13	0.625
TXT6	TXT6D	246366	TA6M	83	143T-326T	25.9	34.2	8.0	18.0	50.0	20.0	6.00	6.06	1.63
TXT7	TXT7D	247390	TA7M	90	143T-365T	30.6	40	10.0	20.0	56.0	23.0	6.00	6.88	0.500
TXT8	TXT8D	248395	TA8	107	213T-365T	35.4	44.2	12.0	25.0	63.0	27.0	6.50	7.46	0.156
TXT9	TXT9D	249395 ▲	TA9	125	213T-365T	38	46.7	12.0	25.0	66.0	30.0	9.00	7.63	2.91
TXT10	TXT10D	250395	TA10	140	254T-445T	42.5	50.8	12.0	25.0	72.5	30.0	9.00	8.25	4.31
TXT12	TXT12D	272688 ♣	TA12	170	320T-445T	58.1	66.6	15.0	30.0	91.0	34.0	9.50	8.13	-

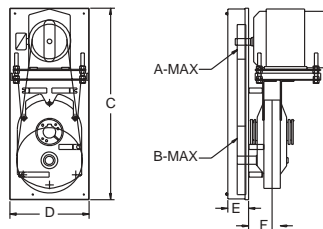

BELT GUARDS FOR SINGLE REDUCTION TXT REDUCERS (5:1) WITH STANDARD MOTOR MOUNTS ■

REDUCER SIZE	BELT GUARD SIZE	PART NUMBER	MOTOR MOUNT NO.	WT.	NEMA MOTOR FRAME	CENTER DISTANCE		A	B	C	D	E	F
						MIN	MAX						
TXT105	TXT1S	241397	TA1M	30	56T-215T	17.6	22.7	5.0	12.0	32.0	13.0	3.50	3.63
TXT205	TXT2S	242397	TA1M	36	56T-215T	18.7	23.9	6.0	13.0	34.0	15.0	4.00	3.50
TXT305A	TXT3S	243389 ▲	TA3M	43	56T-215T	20.2	25.3	7.0	15.0	37.0	17.0	4.00	3.94
TXT405A	TXT4S	244397	TA4M	54	143T-286T	21.2	28.7	8.0	16.0	43.0	18.0	4.50	5.19
TXT505A	TXT5S	245389 ▲	TA5M	59	143T-286T	22.7	30.2	8.0	16.0	45.0	18.0	5.25	5.13
TXT605	TXT6S	246368	TA6M	95	143T-326T	25.9	34.2	10.0	18.0	50.0	20.0	6.00	6.06
TXT705	TXT7S	247392	TA7M	112	143T-365T	30.6	40.0	10.0	25.0	58.0	27.0	6.00	6.88
TXT805	TXT8S	248397	TA8	125	213T-365T	35.1	43.9	13.0	30.0	66.0	32.0	6.50	7.46
TXT905	TXT9S	249397 ▲	TA9	156	213T-365T	37.6	46.4	13.0	30.0	69.0	32.0	9.00	7.63

▲ These belt guards do not fit the larger frame, higher H.P. TORQUE-ARM motor mounts on pages G2-72 and G2-73.

■ These belt guards do not fit TAB Bottom Motor Mounts. Consult DODGE for made-to-order belt guards for use with Bottom Motor Mounts

♣ Made to order.

FEATURES/BENEFITS PAGE G2-3	NOMENCLATURE PAGE G2-11	SELECTION/DIMENSIONS PAGE G2-28	RELATED PRODUCTS PAGE G2-152
--------------------------------	----------------------------	------------------------------------	---------------------------------



TORQUE-ARM Shaft Mount Speed Reducers

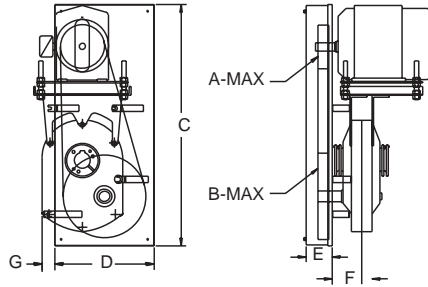

BELT GUARDS FOR DOUBLE REDUCTION TXT REDUCERS (9, 15, 25:1) WITH LONG MOTOR MOUNTS

REDUCER SIZE	BELT GUARD SIZE	PART NUMBER	MOTOR MOUNT NO.	WT.	NEMA MOTOR FRAME	CENTER DISTANCE		A	B	C	D	E	F	G
						MIN	MAX							
TXT3A	TXT3DLMM	243153 ▲	TA3ML	52	56T-215T	23.1	28.3	7.0	14.0	40.0	17.0	4.00	3.94	-
TXT4A	TXT4DLMM	244151	TA4ML	65	143T-286T	25.6	33.1	7.0	15.0	47.5	18.0	4.50	5.19	-
TXT5B	TXT5DLMM	245102 ▲	TA5ML	90	143T-286T	29.4	36.8	7.0	15.0	51.7	18.0	4.25	5.13	0.625
TXT6	TXT6DLMM	246147	TA6ML	100	143T-326T	39.8	48.1	8.0	18.0	64.0	20.0	6.00	6.06	1.63
TXT7	TXT7DLMM	247152	TA7ML	108	143T-365T	46.0	55.3	10.0	20.0	71.5	23.0	6.00	6.88	0.500

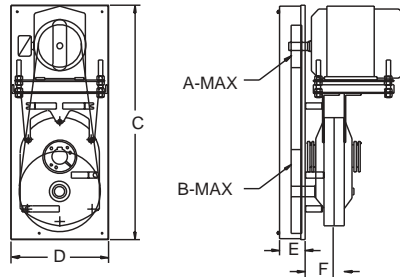

BELT GUARDS FOR SINGLE REDUCTION TXT REDUCERS (5:1) WITH LONG MOTOR MOUNTS

REDUCER SIZE	BELT GUARD SIZE	PART NUMBER	MOTOR MOUNT NO.	WT.	NEMA MOTOR FRAME	CENTER DISTANCE		A	B	C	D	E	F
						MIN	MAX						
TXT305A	TXT3SLMM	243164 ▲	TA3ML	55	56T-215T	23.1	28.3	7.0	15.0	40.0	17.0	4.00	3.94
TXT405A	TXT4SLMM	244164	TA4ML	65	143T-286T	25.6	33.1	8.0	16.0	47.5	18.0	4.50	5.19
TXT505A	TXT5SLMM	245162 ▲	TA5ML	90	143T-286T	29.4	36.8	8.0	16.0	51.7	18.0	4.25	5.13
TXT605	TXT6SLMM	246132	TA6ML	100	143T-326T	39.8	48.1	10.0	18.0	64.0	20.0	6.00	6.06
TXT705	TXT7SLMM	247146	TA7ML	135	143T-365T	46.0	55.3	10.0	20.0	71.5	23.0	6.00	6.88

▲ These belt guards do not fit the larger frame, higher H.P. TORQUE-ARM motor mounts on pages G2-72 and G2-73

FEATURES/BENEFITS PAGE G2-3	NOMENCLATURE PAGE G2-11	SELECTION/DIMENSIONS PAGE G2-28	RELATED PRODUCTS PAGE G2-152
--------------------------------	----------------------------	------------------------------------	---------------------------------

MODIFICATIONS/ ACCESSORIES



TORQUE-ARM Shaft Mount Speed Reducers BACKSTOP ASSEMBLIES FOR TORQUE-ARM REDUCERS

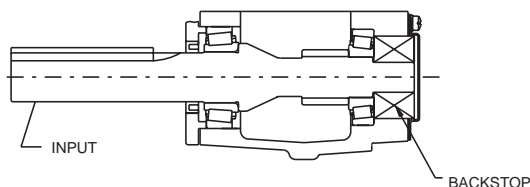

Backstops are offered for service conditions that require the prevention of reverse direction. They can be quickly installed by removing cover plate and slipping the backstop over the input shaft. After cover is replaced, backstop becomes completely sealed inside the reducer case. Since the reducer lubricates the backstop, no additional lubrication is required.

When ordering backstops, specify by reducer size and ratio. Keys are included in each backstop assembly.

Warning: Backstops are not recommended for applications involving energy absorption and shock or torque loads in excess of reducer ratings or on applications such as chair lifts, amusement rides, etc., where the safety of persons or property is dependent on their function. On such applications, other safety devices should be provided.

BACKSTOP ASSEMBLIES ■

Reducer Size	Nominal Ratio	Part Number	Weight
TXT1	5, 9, 15, 25	242101	0.6
TXT2	5, 9, 15, 25	252101	1.0
TXT3A	9, 15, 25	243106	0.6
TXT3A	5	252101	1.0
TXT4A	9, 15, 25	244106	1.2
TXT4A	5	244148	0.9
TXT5B	9, 15, 25	245154	2.2
TXT5A	5	246101	1.8
TXT6	5, 9, 15, 25	246092	2.5
TXT7	5, 9, 15, 25	247260	2.8
TXT8	15, 25	249260	3.8
TXT8	5	250260	5.6
TXT9	15, 26	249260	3.8
TXT9	5	272259	6.7
TXT10	15, 24	250260	5.6
TXT12	15, 25	250260	5.6
TDT13	25	272259	6.7
TDT14	25	272293	13.4
TDT15	30	272293	13.4

■ See page G2-211 for complete listing of Backstop assemblies for all generations of DODGE TORQUE-ARM reducers.

FILTER BREATHERS FOR TORQUE-ARM REDUCERS

FILTER BREATHERS ★



Reducer Size	Part Number	Plug Dimensions
TXT1 to TXT4	430048	3/8-18 NPSF
TXT5 to TXT10	430049	1/2-14 NPSF

★ Breathers fit all reducer ratios.

Filter air breathers are designed for use in dusty atmospheres where the standard Torque-Arm breather may become clogged and inoperative. The 40 micron mesh opening allows the reducer to breathe, yet keep dust out, under the most extreme conditions. Clean oil is necessary for proper service and long gear and bearing life. Breathers may be used in all reducers and screw conveyor drives. When ordering, specify reducer size.



TORQUE-ARM Shaft Mount Speed Reducers AUXILIARY SEAL KITS FOR TORQUE-ARM REDUCERS

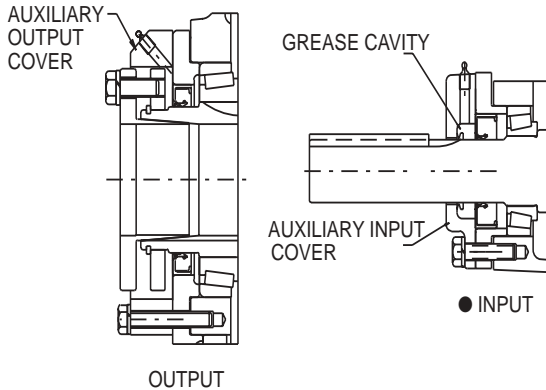

An Auxiliary Seal Kit consists of two output seals and one input seal with necessary mounting hardware. Seal rings are equipped with a standard grease fitting and a large cavity which permits grease purging of the seal in severe applications, such as taconite mining, rock processing, fertilizer processing, etc. Reducer housings, sizes 1 thru 5, must be drilled and tapped to accommodate seal. On sizes 6 and larger, the auxiliary seal bolts to the existing seal carrier, with the longer bolts supplied with the kit. A filter breather is included with each auxiliary seal kit.

AUXILIARY SEAL KITS ★ ■ ●

Reducer Size	Nominal Ratio	Part Number	Reducer Size	Nominal Ratio	Part Number
TXT1	9, 15, 25	272515	TXT6	5, 9, 15, 25	272450
	5	272521		TXT7	5, 9, 15, 25
TXT2	9, 15, 25	272446	TXT8		5, 15, 25
	5	272459		TXT9	5, 15, 26
TXT3A	9, 15, 25	243577	TXT10		15, 24
	5	253186		TXT12	15, 25
TXT4A	9, 15, 25	244676	TDT13		25
	5	254267		TDT14	25
TXT5B	9, 15, 25	245635	TDT15		30
TXT5A	5	255230			

★ For Taper Bushed reducers only.

■ See page G2-203 for dimensions to drill and tap reducer housing for mounting of auxiliary seal kit. Dodge will install upon request.

♣ Made to order

● Input auxiliary seal can not be used on same input shaft with a cooling fan

FEATURES/BENEFITS PAGE G2-3	NOMENCLATURE PAGE G2-11	SELECTION/DIMENSIONS PAGE G2-28	RELATED PRODUCTS PAGE G2-152
--------------------------------	----------------------------	------------------------------------	---------------------------------

MODIFICATIONS/ ACCESSORIES

DODGE®

TORQUE-ARM Shaft Mount Speed Reducers

COOLING FAN ASSEMBLIES FOR TORQUE-ARM REDUCERS

When the thermal capacity of a Torque-Arm reducer is exceeded, cooling fans provide an optional, inexpensive way of lowering the oil temperature, thus increasing the thermal horsepower capacity of the reducer. Selection tables indicate when a cooling fan is required.

Installation is accomplished simply by attaching formed steel mounting straps to the reducer input shaft seal carrier. The fan assembly, which fastens to the input shaft, is compact enough to allow installation of the V-drive originally designed for the reducer. The fan housing is attached

to the outer edges of the straps, which are spaced to allow free circulation of air at the back of the housing as well as through the front of the unit. The fan blade offers a radial streamline air flow which means smaller fans yet a more efficient movement of air.

For thermal capacities beyond the range of cooling fans, heat exchangers may be used-see below.

NOTE: See page G2-205 for maximum input shaft speeds

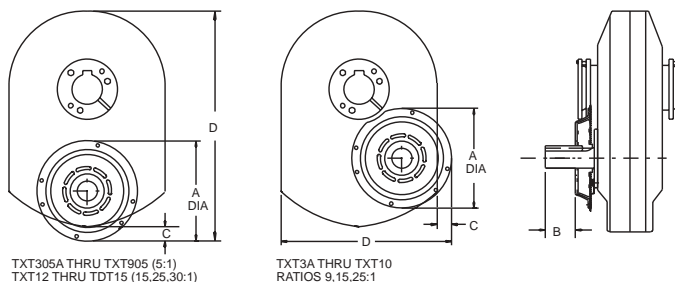

TXT305A THRU TXT905 (5:1)
TXT12 THRU TDT15 (15,25,30:1)

TXT3A THRU TXT10
RATIOS 9,15,25:1

TORQUE-ARM REDUCER COOLING FAN ASSEMBLIES

REDUCER SIZE	COOLING FAN NO.	PART NUMBER	NOMINAL RATIOS	WT.	A	B	C	D
TXT3A, SCXT3A	TXT3A	243581	9, 15, 25	3.0	4.88	2.13	0.15	9.38
TXT305A, SCXT305A	TXT305A	253188	5	3.0	3.94	1.88	-	-
TXT4A, SCXT4A	TDT4	272594	9, 15, 25	3.0	5.88	2.94	0.50	10.88
TXT405A, SCXT405A	TXT405A	254268	5	3.0	4.68	2.94	-	-
TXT5B, SCXT5B	TDT5	272369	9, 15, 25	3.0	7.08	3.44	-	-
TXT505A, SCXT505A	TXT505A	255231	5	3.0	5.75	3.44	-	-
TXT6, SCXT6	TDT6	272325	9, 15, 25	6.0	10.25	3.44	1.31	16.44
TXT605, SCXT605	TXT605	272681 ♣	5	6.0	7.08	3.42	-	-
TXT7, SCXT7	TDT7	272326	9, 15, 25	6.0	12.75	3.68	2.18	20.94
TXT705, SCXT705	TXT705	272685 ♣	5	6.0	9.25	3.88	-	-
TXT8	TDT8	272327	15, 25	9.0	12.75	4.18	2.38	22.63
TXT805	TDT8	272327	5	9.0	12.75	4.25	-	-
TXT9	TDT9	272328	15, 26	15.0	16.75	6.31	3.75	26.38
TXT905	T19	272324 ♣	5	15.0	12.75	7.44	-	-
TXT10	TDT10	272329	15, 24	15.0	16.75	6.13	2.25	27.75
TXT12	TDT12	272330	15, 25	15.0	16.75	5.88	3.25	46.75
TDT13	TDT13	272331	25	20.0	18.50	5.68	3.94	49.75
TDT14	TDT14	272332	25	20.0	18.50	8.63	2.81	52.88
TDT15	TDT15	272333	30	23.0	18.50	9.50	2.00	60.63

♣ MADE TO ORDER

REDUCER HEAT EXCHANGER COOLING PACKAGE

For thermal capacities beyond the range of cooling fans, an optional heat exchanger cooling package is available to prevent overheating the reducer and allow the use of full mechanical HP rating by lowering the oil temperature to an acceptable level.

Specifications for the heat exchanger motor are as follows:
1/2 hp, 60 Hz, 3Ph. 230/460 Volt, TEFC, 56 Frame.
Minimum coolant (water) flow is 3 G.P.M. based upon a maximum water temperature of 80°F.
Minimum oil temperature for operation is 60°F.



Part Number

014148 ♣

♣ Made to order

FEATURES/BENEFITS
PAGE G2-3

NOMENCLATURE
PAGE G2-11

SELECTION/DIMENSIONS
PAGE G2-28

RELATED PRODUCTS
PAGE G2-152